



BLUINTERNI[®]
SMART FURNISHINGS

La progettualità e il design Bluinterni aprono nuove porte, creano nuovi spazi.

Planning and design
Bluinterni open new doors,
create new spaces



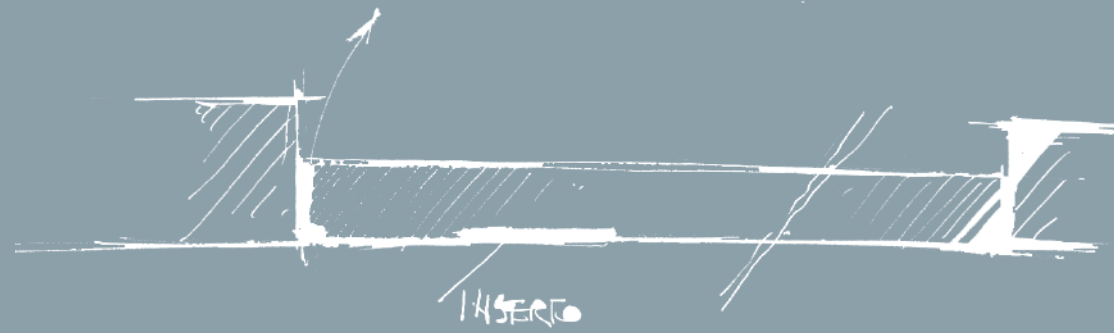

Le porte Bluinterni chiudono gli spazi, ma aprono infinite possibilità progettuali; dividono gli ambienti, ma uniscono alla varietà di finiture la forza del design.

Un mondo di soluzioni, dimensioni e materiali per tutte le architetture contemporanee, dalla casa agli ambienti di lavoro, dalle strutture ricettive agli spazi pubblici. Nelle porte **Bluinterni** la funzionalità incontra la ricercatezza estetica, come nella nuova anta Twist, realizzata in collaborazione con l'Arch. Marco Fumagalli. Assoluta flessibilità e massima personalizzazione per porte che arredano.

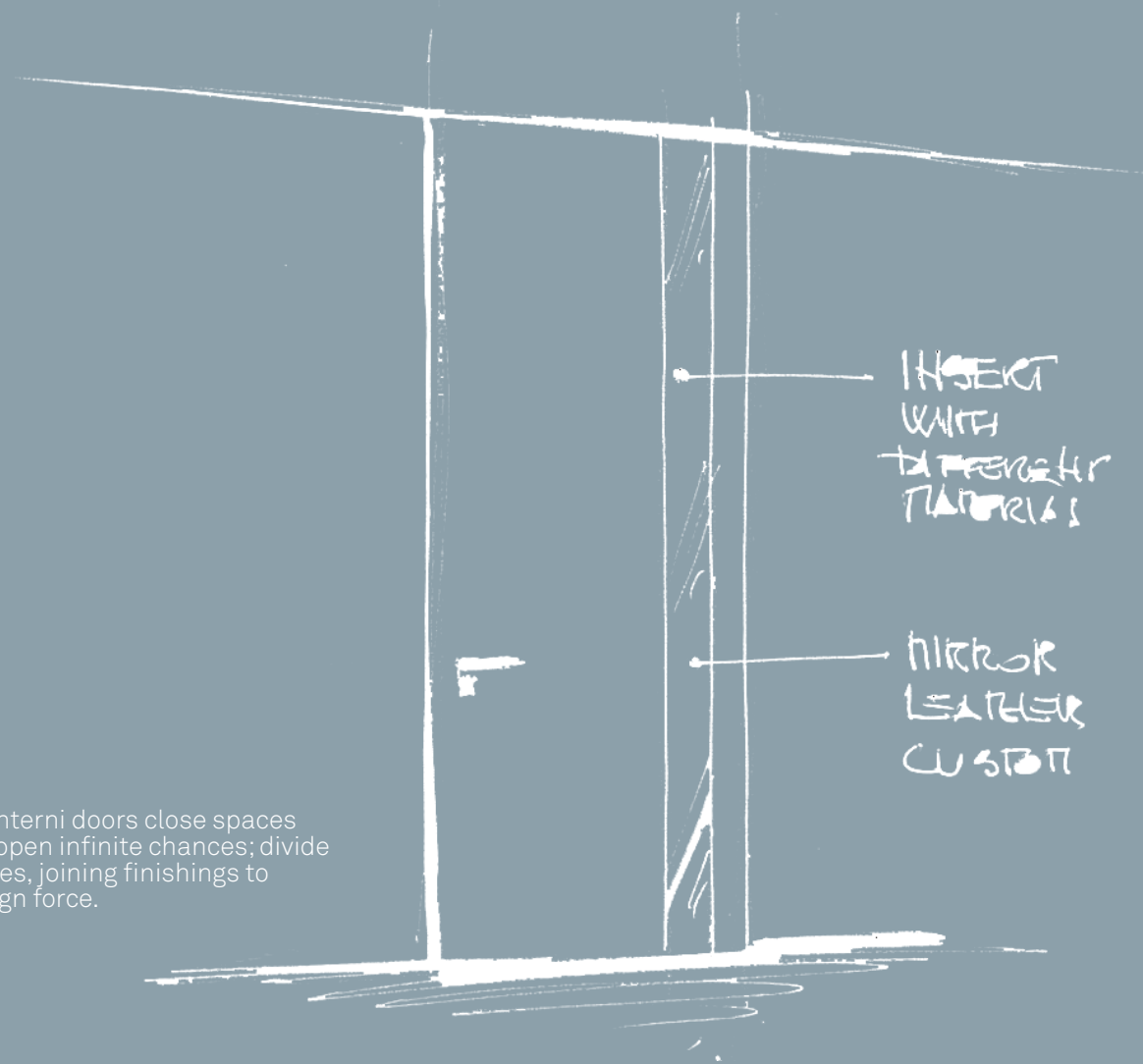

Bluinterni doors close spaces but open infinite chances; divide places, joining finishings to design force.



A world of solutions, dimensions and materials for all actual architectures, starting from house, reaching offices to public spaces. In Bluinterni doors functionality meets aesthetic point of view, as in the new door Twist, realized with Arch. Marco Fumagalli. Total flexibility and maximum customization for design doors.

Apertura BATTENTE

SWING SYSTEM



Telaio_Frame	
B-LINE	_08
B-FRAME	_10
Anta / Door	
TWIST	_12
PLANA	_20
WALL	_70
DUAL	_27/51
Telaio_Frame	
VITRUM-LINE	_78
Anta Vetro / Glass Door	
PLANA	_80
Telaio_Frame	
B-LICO	_86
Anta / Door	
MONO 45	_88
B 52	_90

Chiusure SPECIALI

SPECIAL CLOSING



Telaio_Frame	
CUBBY	_136
Aperture_Opening	
TIRARE	
Pull	
RIBALTA	
Bottom-Hinged	
VASISTAS	
Vasistas	
BOTOLA	
Ceiling Trapdoor	

Specifiche TECNICHE

TECHNICAL SPECIFICATION



TELAI	_144
Frames	
MANIGLIE	_150
Handles	
FINITURE	_154
Finishings	
VETRI	_164
Glasses	

Apertura SCORREVOLE

SLIDING SYSTEM



Binario / Rail	
B-MOVE	_100
Sistema di scorrimento_	
Sliding system	
SKY	_104
MULTY	_108
MAGIC	_111
BASIC	_116
LUCE-B	_120
LUCE-S	_118
MINIMA	_122
Anta / Door	
TWIST	
PLANA	
WALL	
DUAL	
Binario / Rail	
VITRUM-MOVE	_102
Sistema di scorrimento_	
Sliding system	
SKY-B	_105
SKY-S	_105
MULTY	_113
MAGIC	_112
BASIC	_114
LUCE-B	_121
LUCE-S	_121
MINIMA	_125
Anta / Door	
PLANA	

Sistema QUADRO

SLIDING SYSTEM



Anta-Binario / Door-Rail	
QUADRO	_126

Apertura BATTENTE

SWING SYSTEM

Il sistema più classico di apertura per ambienti contemporanei. Soluzioni raso muro che danno un nuovo valore allo spazio o con stipite per incorniciare la bellezza della porta.

The most classic opening system for actual spaces. Flush to wall solutions that give a new value to the space or with jamb to frame the beauty of the door.

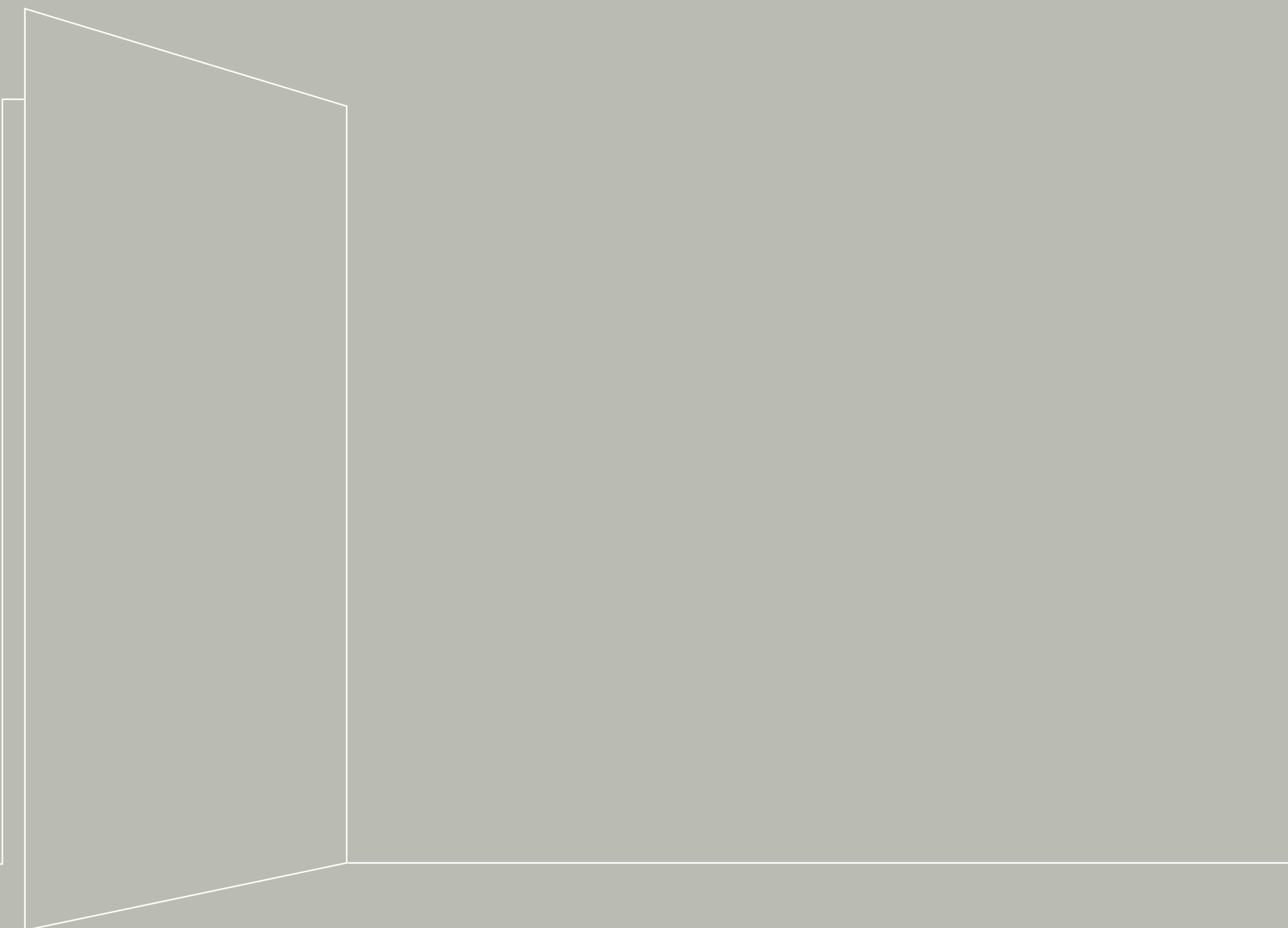

Struttura raso muro o con stipite da abbinare a diverse tipologie di ante per creare infinite combinazioni.

Flush to wall structures or with jamb to match to different kind of door panels, in order to create infinite mixture



Telaio / Frame

B-LINE
B-FRAME

Anta / Door

TWIST
PLANA
DUAL
WALL

Telaio B-LINE

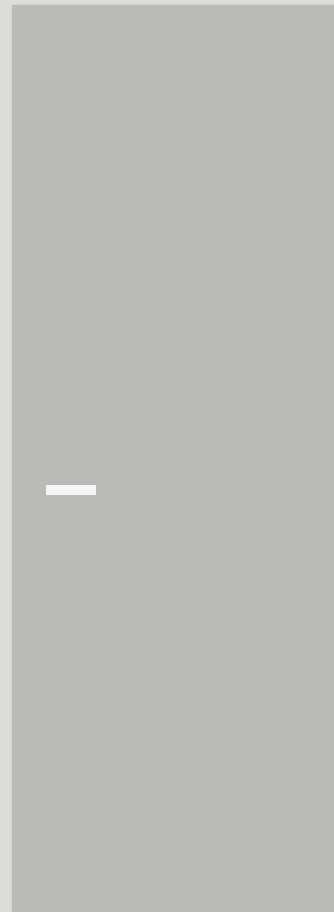

Struttura raso muro e grande libertà dimensionale in larghezza e in altezza, anche nella soluzione a filo soffitto. B-Line non ha confini.

Flush to wall structures and big freedom in both width and height dimensions, even if in ceiling solution. B-Line has not borders.

CON TRAVERSO
WITH BEAM

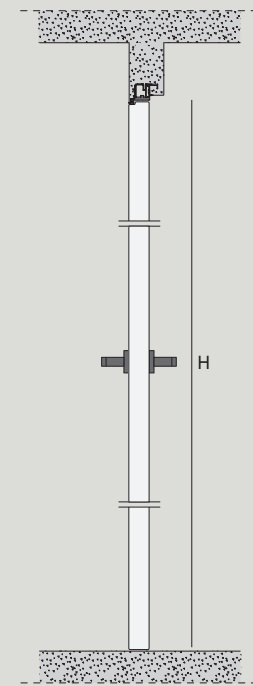

Altezze da 2000 a 3400 mm.
Height from 2000 to 3400 mm.

SENZA TRAVERSO
WITHOUT BEAM

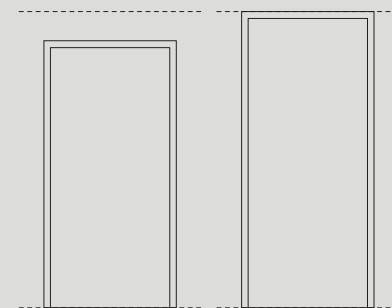
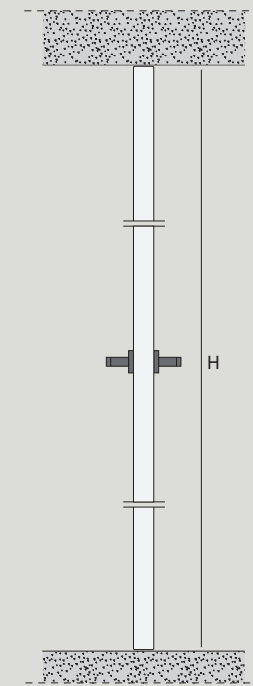

B-Line è anche porta a tutta altezza, con o senza traverso, per un effetto di totale linearità tra anta e soffitto.

B-Line reaches the ceiling, with or without beam, in order to have a total linearity between door panel and ceiling.

PORTA A TIRARE PULL DOOR



MURATURA
BRICKWALL

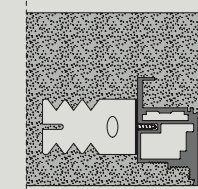

CARTONGESSO
PLASTERBOARD

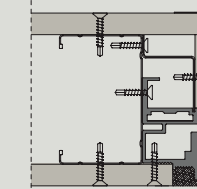

B-Line a tirare permette un'apertura verso l'esterno, lato in cui è presente il rasomuro. L'apertura può essere a destra o a sinistra.

B-Line pull door permits an opening toward the outer side, which is the flush side. Opening may be right or left.

SINGOLA
SINGLE

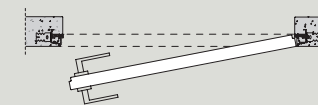

Larghezza da 600 a 1000 mm.
Width from 600 to 1000 mm.

DOPPIA
DOUBLE

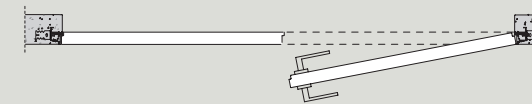

Larghezza da 1200 a 1800 mm.
Width from 1200 to 1800 mm.

PORTA A SPINGERE PUSH DOOR



MURATURA
BRICKWALL

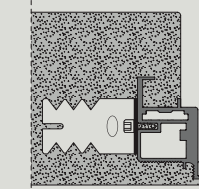

CARTONGESSO
PLASTERBOARD

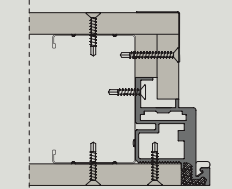

B-Line a spingere permette l'apertura con una spinta verso l'interno della stanza. L'apertura può essere a destra o a sinistra.

B-Line push door permits an opening toward the inner side of the room. Opening may be right or left.

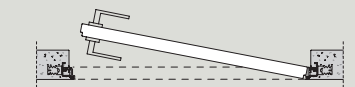

Larghezza da 600 a 1000 mm.
Width from 600 to 1000 mm.

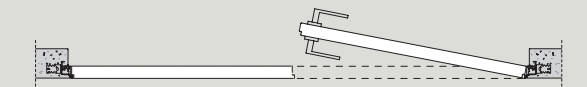

Larghezza da 1200 a 1800 mm.
Width from 1200 to 1800 mm.

Telaio B-FRAME

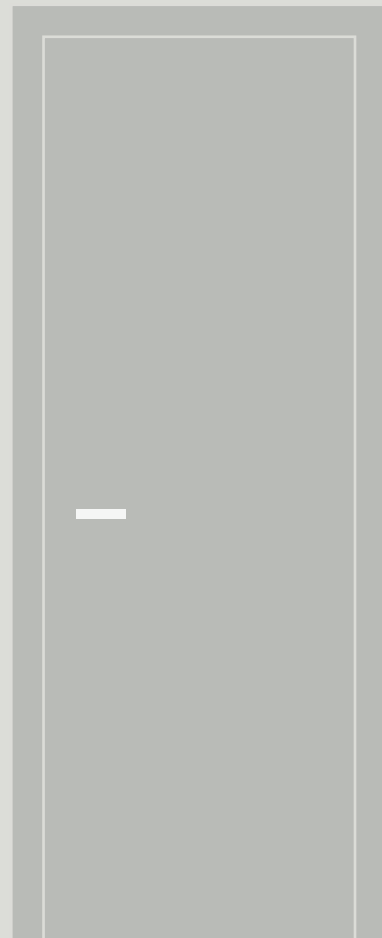

B-Frame è la porta con stipite dallo spessore sottile, che mantiene una perfetta complanarità. Dimensioni personalizzabili anche nella soluzione a filo soffitto.

B-Frame is the door with a thin jamb. It keeps an alignment. Customized dimensions in both width and height, even if in ceiling solution.

CON TRAVERSO
WITH BEAM

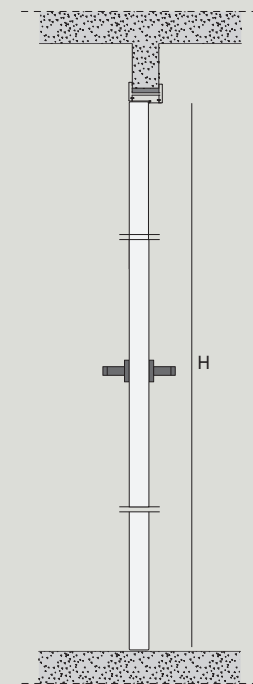

Altezze da 2000 a 2700 mm.
Height from 2000 to 2700 mm.

SENZA TRAVERSO
WITHOUT BEAM

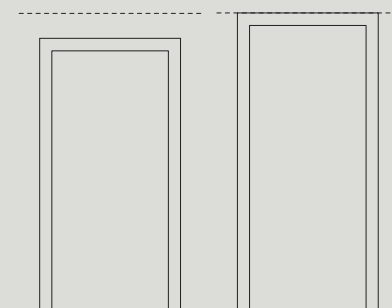
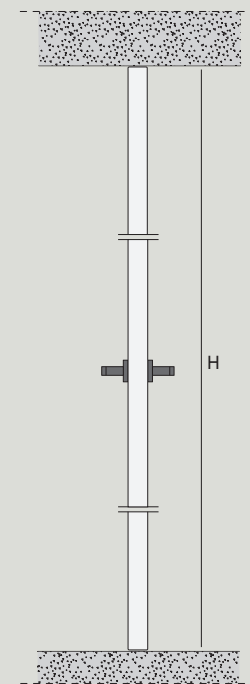

L'altezza di B-Frame può arrivare a filo soffitto, con o senza traverso superiore, per combinare lo stipite classico con la modernità delle soluzioni.

The height of B-Frame can reach the ceiling, with or without the upper beam, in order to match classical jamb to modern solutions.

PORTA A TIRARE
PULL DOOR



MURATURA
BRICKWALL

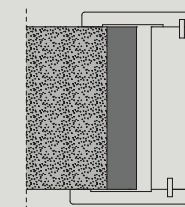

CARTONGESSO
PLASTERBOARD

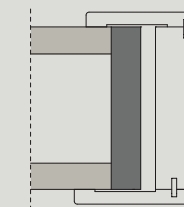

B-Frame con apertura a tirare verso l'esterno è predisposta per l'installazione su parete in intonaco oppure con struttura in cartongesso.

B-Frame with pull opening toward the outer side is prearranged for the installation on both brickwall or plasterboard.

SINGOLA
SINGLE

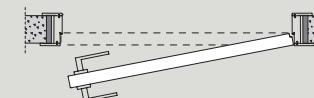

Larghezza da 600 a 900 mm.
Width from 600 to 900 mm.

DOPPIA
DOUBLE

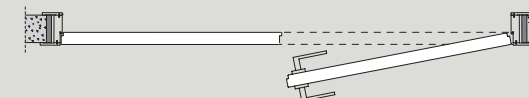

Larghezza da 1200 a 1800 mm.
Width from 1200 to 1800 mm.

PORTA A SPINGERE
PUSH DOOR



MURATURA
BRICKWALL

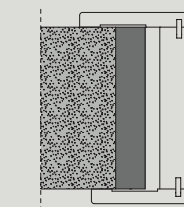

CARTONGESSO
PLASTERBOARD

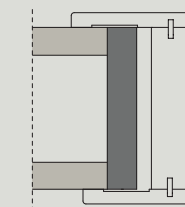

B-Frame a spingere si apre verso l'interno e può essere installata su parete in muratura oppure con struttura in cartongesso.

B-Frame with push opening opens toward the inner side and may be installed on both brickwall or plasterboard.

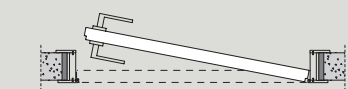

Larghezza da 600 a 900 mm.
Width from 600 to 900 mm.

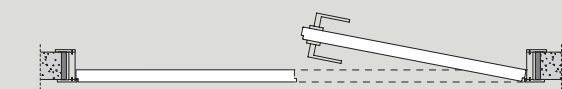

Larghezza da 1200 a 1800 mm.
Width from 1200 to 1800 mm.

Abbinamenti d'effetto per porte che sono elementi d'arredo. Il decor è verticale e la varietà di materiali permette di dare un tocco creativo alle pareti.

Matches of effect and style for designed doors. Vertical decoration and a variety of material permit to give a creative touch to walls and a character to rooms.



Anta TWIST

TWIST DOOR

PORTA Door	LACCATI OPACHI Matt Lacquers
INSERTI Insert	VETRO LACCATO Lacquered glass
	SPECCHIO Mirror
	ALUTES Alutes
	PIETRA Stone
	IMPACT Impact
	ECOCUOIO Eco-Leather

Total WHITE

bianco e
vetro sono un
dress code
intramontabile
per tutti i tipi di
spazi e ambienti.

Total White
white and glass are a
timeless dress code for
all environment.



B-Line
L 80 x H 240
L001 Laccato Bianco Opaco/ VL01 Vetro Bianco
Matt White Lacquered/ White Glass

—
FINISHES

Effetto DECOR

DÉCOR EFFECT



Vetro, Specchio, Pietra,
Alutes, Ecocuoio
e Impact: sei
materiali in diverse
finiture da abbinare
al laccato opaco
per creare originali
fasce decorative
sulle porte.

Glass, Mirror, Stone,
Alutes, Eco-leather
and Impact: six
materials in different
finishings to match
to matt lacquered, in order
to create original
decorative strip on doors.



B-Line
L 80 x H 240
L004 Laccato Crema Opaco / SL01 Impact Bronze...
Matt Cream Lacquered / Impact Bronze

Decorare il DESIGN

superfici lisce e inserti materici per interiors contemporanei.

Decorate the Design smoothly surfaces and metallic inserts for contemporary interiors.



B-Line
L 80 x H 270
L019 Laccato Fumo Opaco / PS01 Pietra Shine
Matt Smoke Lacquered / Shine Stone



B-Line
L 80 x H 270
L015 Laccato Canapa Opaco / SA12 Specchio Antico Oro
Matt Hemp Lacquered / Gold Antique Mirror

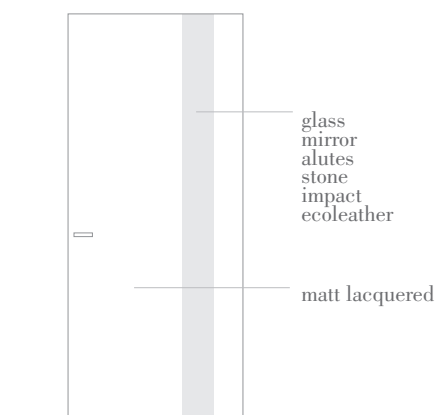

Lo specchio antico oro è un decoro senza tempo.

Antique gold mirror is a timeless décor.

La versatilità delle dimensioni, il minimalismo del raso muro o la classicità dello stipite, un'ampia scelta di materiali, che va dai legni naturali o colorati ai laccati fino alle finiture speciali: scegliere le porte per dare personalità agli spazi.

Dimensions versatility, flush to wall minimalism and classical effect of jamb, a wide range of materials, going from natural or coloured wood, passing through lacquered to special finishings: choose doors in order to customize spaces.



Anta PLANA

PLANA DOOR

ROVERE
Oak

FRASSINO MATÈ
Matè Ash

ROVERE LACCATO
Lacquered Oak

LACCATI OPACHI/LUCIDI
Matt/Glossy Lacqueres

CEMENTO/PIETRA/SPECCHIO
Cement/Stone/Mirror

ALUTES
Alutes

ECOCUOIO
Eco-Leather

Tutte le sfumature del
LEGNO

il piacere naturale di una porta che arreda.

All Wood Shades
the natural pleasure of a decorative door.

B-Line
L 80 x H 270
RT02 Rovere Tinto Fango _Mud Stained Oak



B-Line
L 80 x H 270
RA01 Rovere Antico_Antique Oak

Super NATURAL

la trama dei
nodi e delle venature.

Supernatural Wood
knots and veining shape.

La naturalezza
del legno per porte
filo soffitto o con
boiserie. Doppie,
singole o in pendant
con la parete.

Naturalness of
wood for ceiling
door or for boiserie.
Double, single or
match to the wall.

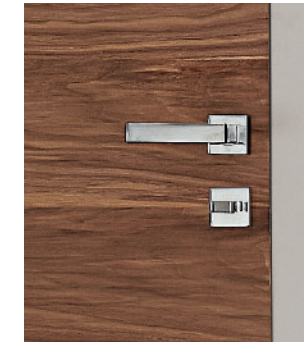

B-Line
L 80 x H 270
NC01 Noce Canaletto_VB01 Vetro Bronzo Trasparente
American Walnut_Transparent Bronze Glass



B-Line_Boiserie
L 80 x H 270
RA02 Rovere Antico Grigio_Grey Antique Oak

Ispirazione NATURA

c'è una vena naturale
in ogni porta.

Twist Style
la versatilità delle dimensioni
con eleganza.



B-Frame
L 80 x H 240
RT03 Rovere Tinto Terra_Terrain Stained Oak

Soluzioni battente
rasostipite,
singole o doppie,
per tutti i tipi di
ambiente.

Swing solution with jamb,
single or double for
every space.



B-Frame
L 80 x H 240
RN01 Rovere Naturale_Natural Oak



L'anta Dual
abbina legno
e vetro con
originalità. Nella
versione B-Line,
la cornice è
parte dell'anta,
decore la porta
e crea un effetto
coordinato con
l'ambiente.

Dual door matches
wood and glass
with originality.
Into B-Line version,
the frame is a
part of the door.
It decorates the
door and creates a
coordinate effect
with the space
around.

B-Line DUAL
L 80 x H 240
RT04 Rovere Tinto Moka/
VV02 Vetro Extrachiaro Satinato_
Moka Stained Oak/
Satin Glass Extraclear

FINISHES

L'eleganza del **FRASSINO** **MATE**

Venature fitte
e materiche
portano in casa
la sensazione
del legno appena
tagliato in sei
tonalità.

Mate' Ash Elegance
dense and material
vains bring at home
the sensation of
the cut wood in six
colours.

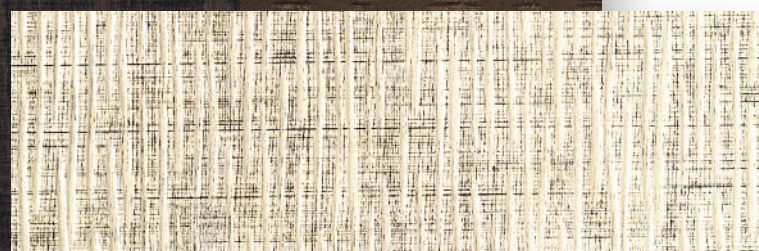

Questione di STILE

legno sulle ante per dare
calore alle pareti.

Style Matter
wood on doors, in order to
give warmth to wall.

B-Line
L 80 x H 210
FM07 Frassino Matè Antracite_Matè Ash Antracite

Venature
TRENDY

texture in rilievo raccontano
molteplici modi di abitare.

Trendy Veining
textures in elevation tell vary
living situations.



B-Line
L 80 x H 240
FM05 Frassino Matè Marrone_Matè Ash Brown



B-Line
L 80 x H 240
FM06 Frassino Matè Tabacco_Matè Ash Tobacco



Le nuove
interpretazioni del
frassino accolgono in
casa accenni di natura
da vivere indoor. B-Line
è la scelta di tendenza
per atmosfere
decisamente
contemporanee.

New interpretation
of ash accepts in
the house natural
hints, to live indoor.
B-Line is the
trendy choice for
contemporary
situations.

B-Line
L 80 x H 240
FM08 Frassino Matè
Polvere_Matè Ash Dust

Passione
BOISERIE

total look in versione materica
per ambienti coordinati.

Boiserie Passion
total look in materical version for
matched environment.

B-Line-Boiserie
L 80 x H 240
FM06 Frassino Matè Tabacco_Matè Ash Tobacco

FINISHES

La
versatilità del
**ROVERE
LACCATO**

Delicate venature
a tinta unita
aprono le porte
a infinite soluzioni
personalizzate.

Lacquered
Oak Versatility
discreet veins in plain
colour open doors to
infinite customized
solutions.

Design a tutta
ALTEZZA

la raffinatezza del filo soffitto per
estendere lo spazio.

Ceiling Design
ceiling refinement, in order
to enlarge the space.



B-Frame
L 80 x H 270
RL03 Rovere Laccato Perla_Pearl Lacquered Oak



B-Line
L 80 x H 240
RL19 Rovere Laccato Fumo_Smoke Lacquered Oak

Tonalità neutre
chiaro o scuro per
porte raso muro che
fanno tendenza e
donano agli interni
un sofisticato effetto
naturale.

Neutral tones,
clear or dark for
flush doors that
make design and
give to the inner
a natural and
advanced effect.



B-Line con sopra luce_with overpanel
L 80 x H 270
RL15 Rovere Laccato Canapa_Hemp Lacquered Oak



Con o senza sopra luce,
le porte valorizzano le
pareti con effetti visivi
dinamici e moderni.
I dettagli lasciano
il segno.

With or without over
panel, doors give value
to walls with dynamic
and modern figurative
effects. Details leave
a sign.

B-Line
L 80 x H 240
RL10 Rovere Laccato Ardesia_
Slate Lacquered Oak



B-Frame doppia_Double
L 80+80 x H 240
RL02 Rovere Laccato Burro_Butter lacquered Oak

Bianco è CHIC

luce agli ambienti e leggerezza
alle porte.

White is Chic
light to environment
and to doors.



B-Frame
L 80 x H 210
RL01 Rovere Laccato Bianco_White Lacquered Oak



B-Line
L 80 x H 240
RL01 Rovere Laccato Bianco_White Lacquered Oak

Il bianco, in tutte le sue gradazioni, riveste porte singole o doppie, con o senza stipiti, per ambientazioni molto soft.

White, in all its tones, dresses single or double doors, with or without jamb, for soft situations.

FINISHES

La modernità dei LACCATI OPACHI E LUCIDI

Superfici lisce in diverse tonalità, lucide per illuminare l'ambiente o effetto matt per dare forza al colore.

Modernity of Lacquered Matt and Glossy smoothly surfaces in different tones, glossy to light up rooms or matt to give force to the colour.



Multy COLOR

le porte trasformano gli
spazi con il colore.

Multy Coloured
doors modify spaces
with color.



4

3

20

B-Line
L 80 x H 270
RAL 6033/ RAL 6024/ RAL1023/ RAL1037
Laccato Opaco_Matt Lacquered



B-Line
L 80 x H 270
LL01 Laccato Lucido Bianco_Glossy White Lacquered

Bianco lucido raso
muro o nero opaco
con stipite per
esprimere
mood diversi.

Flush to wall white
glossy or black matt
with jamb, in order to
state different mood.



B-Frame
L 80 x H 270
L012 Laccato Opaco Nero_Matt Black Lacquered

Look MODERNO

ante glossy o opache
personalizzano gli spazi.

Modern Look
glossy or matt doors
customize spaces.



B-Line doppia_Double
L 80 x H 240
LL03 Laccato Lucido Perla_Glossy Pearl Lacquered

Contrasti FASHION

porte che si fanno notare
per ricercatezza e stile.

Fashion Contrast
doors which draw attention
for care and style.



B-Frame
L 80 x H 240
L001 Laccato Opaco Bianco...
Matt White Lacquered

Laccato e vetro in un dialogo aperto.

Lacquered and glass in
an open conversation.



B-Line Dual
L 80 x H 240
L010 Laccato Opaco Ardesia/ Vetro Extrachiaro Trasparente
Matt Slate Lacquered/ Transparent Extraclear Glass



Il laccato opaco a tutta
anta o in versione Dual
è una scelta che non
passa inosservata e
svela la modernità
degli ambienti.

Matt lacquered on the
whole door or in Dual
version it's a choice
that pass unnoticed and
unveil the modernity
of spaces.

B-Line
L 80 x H 270
L019 Laccato Opaco Fumo...
Matt Smoke Lacquered

FINISHES

Il fascino speciale di CEMENTO PIETRA SPECCHIO

Materiali tattili,
finiture materiche
e superfici
riflettenti dettano
lo stile della casa
e danno unicità
ad ogni ambiente.

Cement Stone Mirror
Special Charmé
tactile material,
material finishings
and reflective
surfaces dictates
houses style and give
uniqueness to
any space.



B-Line
L 90 x H 270
CR03 Cemento Nebbia_Cement Fog

Boiserie
PIETRA

le potenzialità estetiche
di un materiale affascinante.

Stone Boiserie
aesthetical potentiality of a
charming material.

B-Line-Boiserie
L 80 x H 270
P001 Pietra Ocean _Ocean Stone



B-Line
L 80 x H 270
PM01 Pietra Multicolor_Multicolor Stone

La bellezza della MATERIA

il fascino ruvido
di cemento e pietra.

The Beauty of the Material
the rough charme
of cement and stone.



B-Line
L 80 x H 270
CR02 Cemento Ghiaccio_Cement Ice



B-Line con sopra luce_ with overpanel
L 80 x H 270
PS01 Pietra Shine_Shine Stone

La pietra con
divisione in pannelli
e il cemento a tutta
anta interpretano
con accenti diversi
la forza visiva della
matericità.

The stone with
division into panels
and cement on the
whole door comment
with different marks
the visive force
of the material.



B-Line
L 80 x H 240
SP01 Specchio Argento_Silver Mirror



Di riflesso, la
porta amplifica la luce.

Reflecting, the door
amplifies the light.

Porte allo SPECCHIO

argento o bronzo
moltiplicano lo spazio.

Doors on Mirror
silver or bronze, enlarge
the space.



B-Line
L 80 x H 270
SP02 Specchio Bronzo_Bronzed Mirror

FINISHES

Le trame luminose **ALUTES**

Riflessi di seta,
fiori in rilievo e
motivi geometrici
materializzano
l'idea della luce
e diventano raffinati
effetti decorativi.

Light shapes Alutes
Reflected silk,
features flowers
and geometrical drawings
materialize the idea of the
light and become refined
decorative effects.

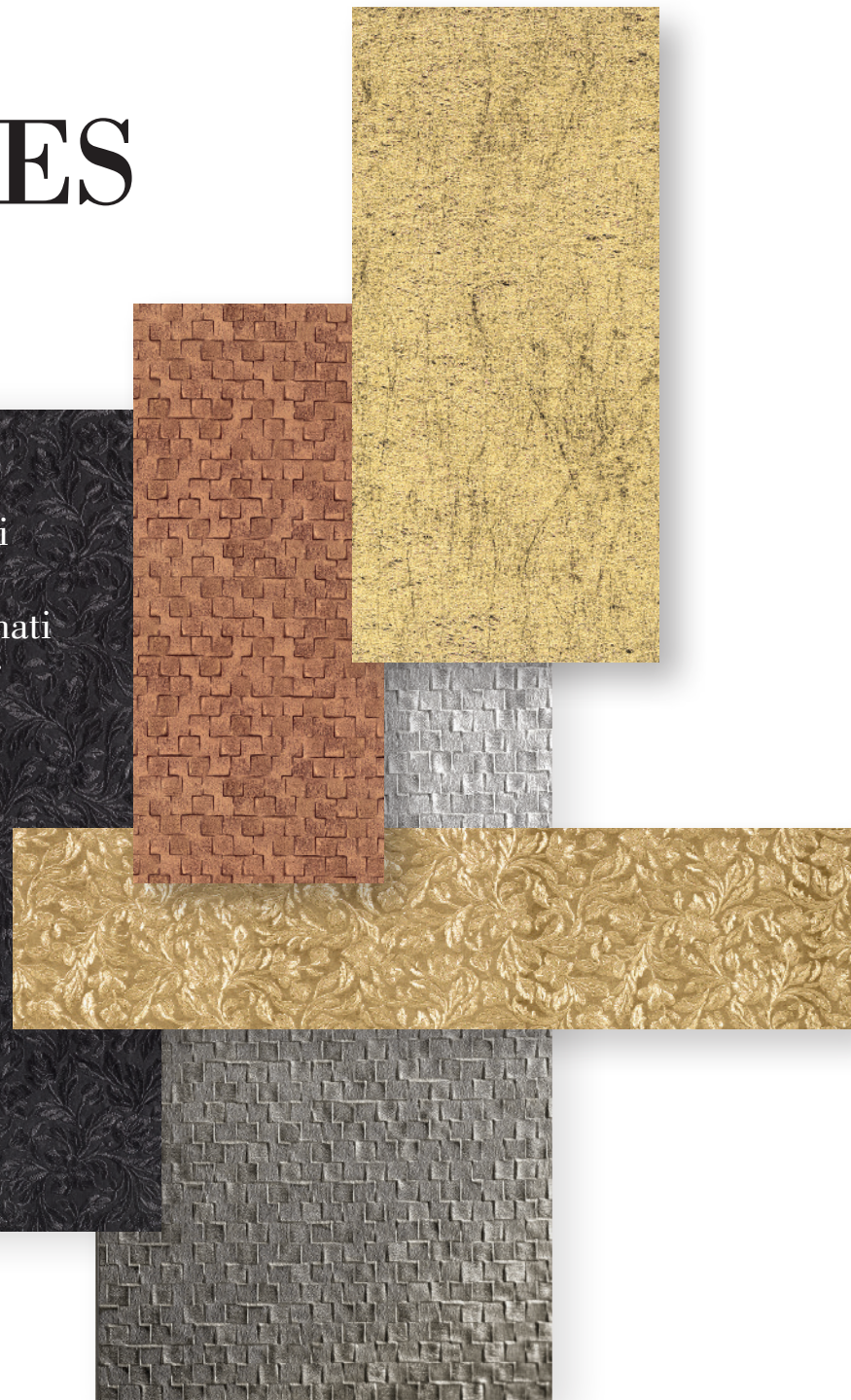

Lo
splendore del
BRONZO

una trama intrecciata scolpisce
la luminosità del materiale.

Bronze Brightness
a stranded shape carves the
brightness of the material.



B-Line_Boiserie
 L 90 x H 240
 QD40 Alutes Square Acciaio_Steel

Le trame lucenti dell'Alutes Silk esprimono il valore della materia e la ricchezza dello stile.

Shining shapes of Alutes Silk convey the value of the material and the wealth of the style.



B-Line
 L 80 x H 340
 SK20 Alutes Silk Oro_Gold



B-Line con sopra luce_ with overpanel
 L 80 x H 270
 QD45 Alutes Square Titanio_Titanium



La finitura in titanio è molto attuale e dà ulteriore preziosità agli intrecci dell' Alutes Square.

Titanium finishing is actual and give more preciousness to Alutes Square.

FINISHES

Lo stile della palette **ECOUCUOIO**

Testa di moro,
bianco, beige,
marrone, rosso,
grigio, blu, nero
o bordeaux per
coordinare le
porte all'arredo.

Ecoleather Style
dark brown, white,
beige, brown, red, grey,
blu, black or bordeaux
in order to match doors
to furnitures.



B-Line
L 80 x H 270
R07 Ecocuio Testa di Moro_Eco-leather Dark Brown



B-Line
L 80 x H 270
R10 Ecocuio Bordeaux_Eco-leather Bordeaux

Porte COUTURE

come una seconda pelle
per la casa.

Couture Doors
like a second skin for
the house.

Le cuciture esprimono la cura
sartoriale anche nelle
grandi altezze.

Steches show
tailored care even in
big heights.



B-Line
L 80 x H 270
R01 Ecocuio Bianco con cuciture Grigio_
Eco-leather White with Grey steaches



La porta a filo soffitto
si veste di ecocuio,
che valorizza
l'atmosfera con un
raffinato effetto
decorativo.

Ceiling door dresses
itself in ecoleather.
It gives value to the
atmosphere with a
refined decorative
effect.

B-Line
L 90 x H 270
R08 Ecocuio Nero con
cuciture Grigio_
Eco-leather Black with
Grey steaches



Anta WALL

WALL DOOR

Effetto camouflage per porta e parete. La decorazione o il colore del muro continuano senza interruzioni sull'anta, che sembra quasi mimetizzarsi e scomparire.

Camouflage effect for door and wall. Garnish or wall colour continue to the door, which seems to disappear.

Wall PAPER

la carta da parati si posa su
porta e parete.

Wall Paper
the wallpaper put itself on
door and wall.

B-Line
L 80 x H 270
Carta da parati/ Malta_ Wallpaper/ Cement



B-Line libro_Folding
L 80 x H 240
Pittura Porta/Parete _Painted Door/Wall



B-Line
L 80 x H 240
Carta da parati _Wallpaper

Il lato **MIMETICO**

la porta vedo-non vedo
integrata nella parete.

Camouflage Side
See - not seen door
integrated to the wall.

Telaio VITRUM-LINE

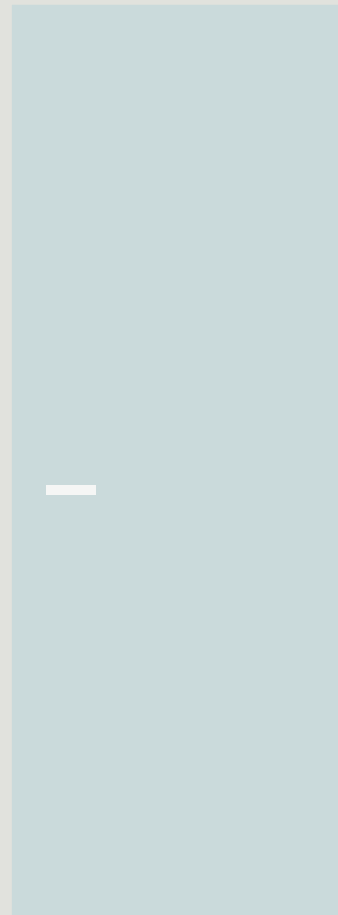

Anta in vetro e struttura raso muro, anche filo soffitto. Vitrum-Line esprime una grande libertà dimensionale e creativa per porte speciali.

Glass door and flush to wall structure, ceiling too. Vitrum-Line states a dimensional and creative freedom for special doors.

CON TRAVERSO
WITH BEAM

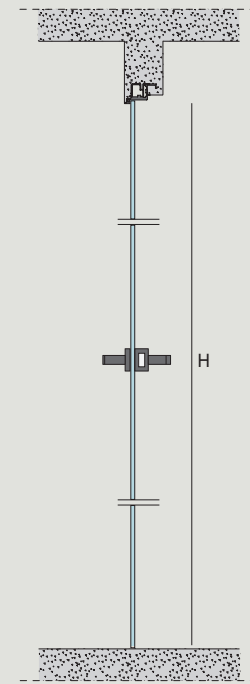

SENZA TRAVERSO
WITHOUT BEAM

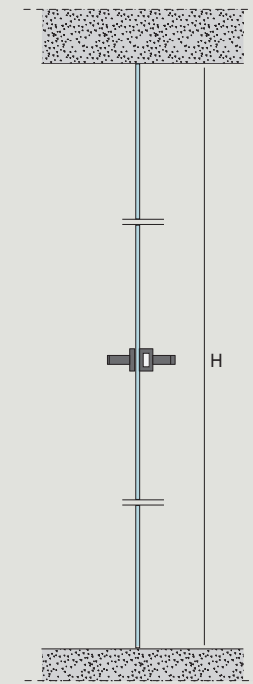

Altezze da 2000 a 2700 mm.
Height from 2000 to 2700 mm.

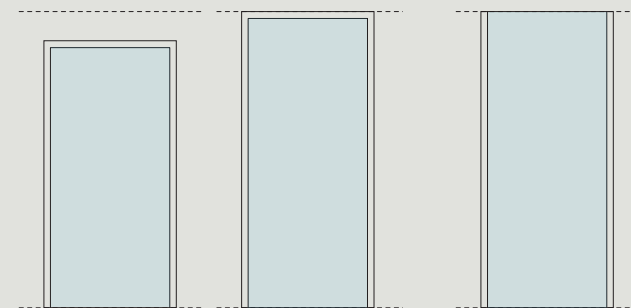

Vitrum-Line è anche porta a tutta altezza, con o senza traverso, per ottenere la massima integrazione tra porta, parete e soffitto.

Vitrum-Line can also reach the ceiling, with or without beam, in order to obtain a joining between door, wall and ceiling.

PORTA A TIRARE
PULL DOOR



PORTA A SPINGERE
PUSH DOOR



MURATURA
BRICKWALL

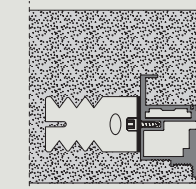

CARTONGESSO
PLASTERBOARD

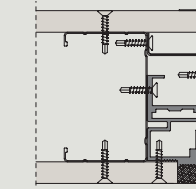

Vitrum-Line a tirare permette un'apertura verso l'esterno, lato in cui è presente il rasomuro. L'apertura può essere a destra o a sinistra.

Vitrum-Line pull door permits an opening toward the outer side, which is the flush side. Opening side can be right or left.

MURATURA
BRICKWALL

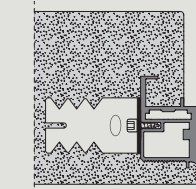

CARTONGESSO
PLASTERBOARD

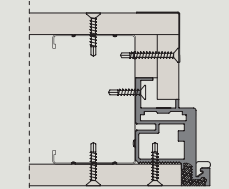

Vitrum-Line a spingere permette l'apertura con una spinta verso l'interno della stanza. L'apertura può essere a destra o a sinistra.

Vitrum-Line permits to open pushing toward the inner side of the room. Opening side can be right or left.

SINGOLA
SINGLE

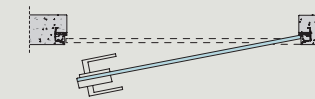

Larghezza da 600 a 900 mm.
Width from 600 to 900 mm.



Larghezza da 600 a 900 mm.
Width from 600 to 900 mm.

DOPPIA
DOUBLE

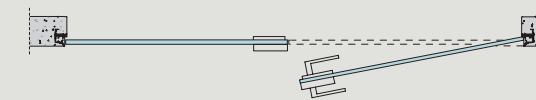

Larghezza da 1200 a 1800 mm.
Width from 1200 to 1800 mm.

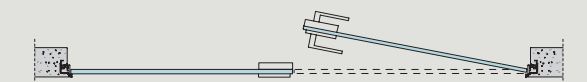

Larghezza da 1200 a 1800 mm.
Width from 1200 to 1800 mm.

La
praticità del
SATINATO

il vetro sceglie l'opacità,
ma non rinuncia alla
lucentezza.

Practicality of Satin
the glass chooses the matt effect, but
doesn't give up the lightness.



Vitrum-Line
L 80 x H 240
VB02 Vetro Bronzo Satinato_Satin Bronzed Glass

Oltre il VETRO

porte leggere per architetture luminose.

Over the Glass light doors for lighting architectures.



Vitrum-Line
L 80 x H 240
VY02 Extrachiaro Satinato_Satin Extraclear



Vitrum-Line
L 80 x H 270
VG02 Grigio Trasparente_Transparent Grey



La grande versatilità dimensionale in altezza e larghezza garantisce sempre un perfetto inserimento in ogni ambiente.

The great versatility in dimensions, both width and height, guarantees always a perfect integration to any environment.

Vitrum-Line
L 80 x H 270
VB01 Bronzo Trasparente_Transparent Bronzed



Vitrum-Line
L 80 x H 240
Vitrum-Digital Spazio
VV01 Extrachiaro Trasparente_
Trasparent Extraclear



Vitrum-Line
L 80 x H 240
Vitrum-Digital Zeronove
VL12 Nero Laccato_
Black Lacquered



Varietà di forme decorative e di soluzioni cromatiche per porte al centro dell'attenzione.

Variety of decorative shapes and chromatic solutions for doors put on middle point.

Vitrum-Line
L 80 x H 240
Vitrum-Marrakech
V001 Extrachiaro_
Extraclear

Preziosi DECORI

il vetro vive una nuova stagione creativa.

Precious Garnishes
the glass lives a new creative season.

Telaio B-LICO MONO45

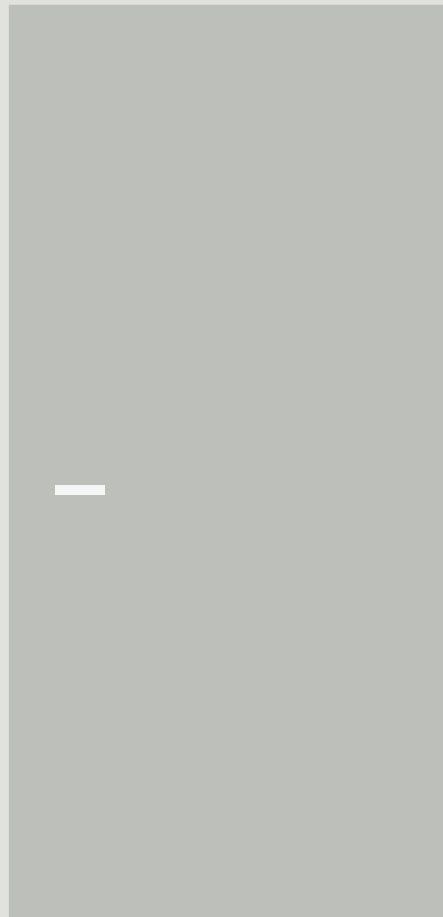

Porta con apertura monodirezionale e spessore dell'anta 45 mm. Grande funzionalità della porta e massima praticità in tutte le situazioni.

Door with monodirectional opening and thickness of 45 mm. Big functionality of the door and maximum practicality for any solution.

CON TRAVERSO
WITH BEAM

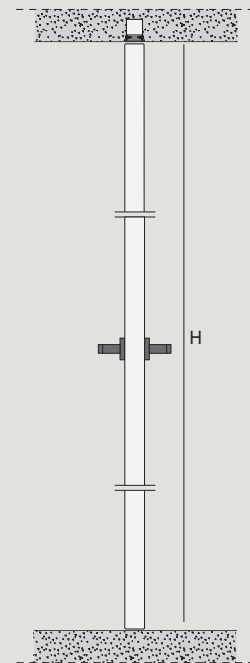

Altezze fino a 3000 mm.
Height up to 3000 mm.

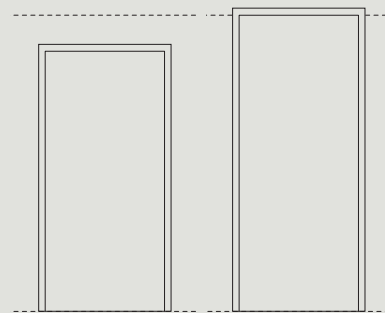

Il bilico monodirezionale è disponibile anche a tutta altezza con traverso. Per ogni spazio, la giusta soluzione.

Monodirectional pivot is available also till the ceiling with beam. For any space, the right solution.

PORTA A TIRARE
PULL DOOR



MURATURA
BRICKWALL

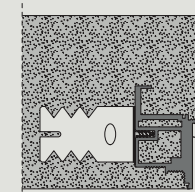

CARTONGESSO
PLASTERBOARD

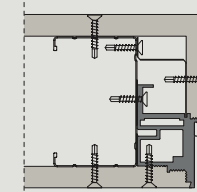

La porta a bilico monodirezionale è disponibile a tirare, con apertura a destra o a sinistra. La doppia scelta è importante per poter gestire al meglio gli spazi.

Door with monodirectional opening, available with pull opening, toward right or left. The double choice is important to manage spaces in a better way.

SINGOLA
SINGLE

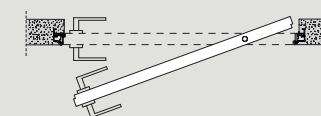

Larghezza fino a 1250 mm.
Width up to 1250 mm.

PORTA A SPINGERE
PUSH DOOR



MURATURA
BRICKWALL

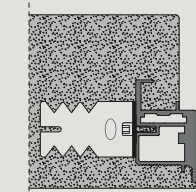

CARTONGESSO
PLASTERBOARD

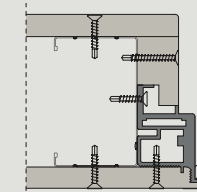

La porta a bilico monodirezionale può essere a spingere, con apertura a destra o a sinistra. Per scegliere sempre la soluzione più adatta.

Monodirectional pivot door can have push opening, toward right or left, in order to chose always the more convenient solution.

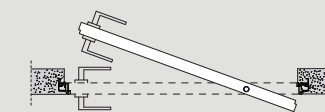

Larghezza fino a 1250 mm.
Width up to 1250 mm.

Telaio B-LICO B52

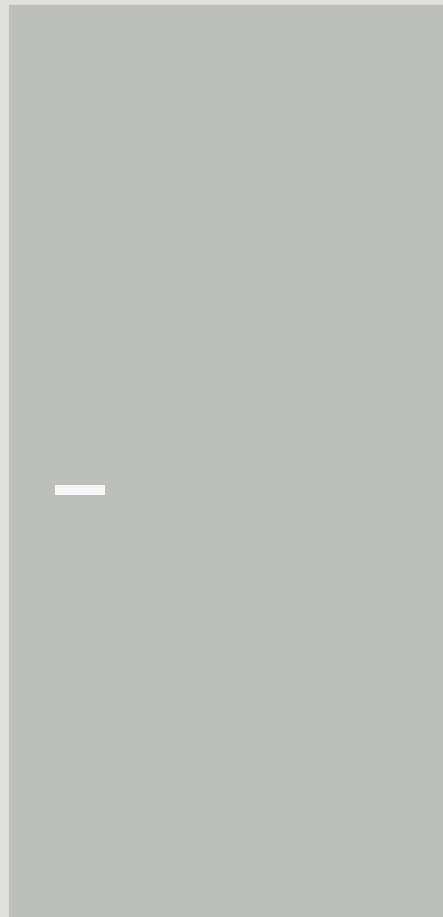

B52 con apertura bidirezionale e spessore dell'anta 52 mm ruota attorno al proprio asse verticale e può essere aperta sia verso destra, sia verso sinistra.

B52 with bidirectional opening and thickness of 52 mm turns around its vertical axis and can be opened on both sides, right and left.

CON TRAVERSO
WITH BEAM

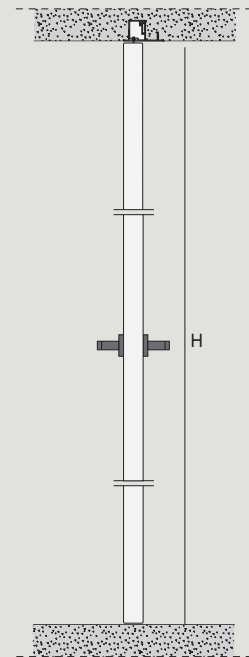

Altezze fino a 3000 mm.
Height up to 3000 mm.

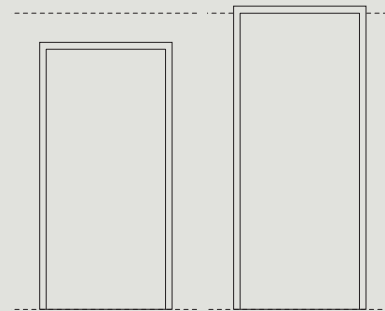

Il bilico bidirezionale è disponibile anche a tutta altezza con traverso ed è pensato soprattutto per gli ampi spazi.

Bidirectional pivot is available ceiling with upper beam and it has been thought for big spaces.

PORTA BIDIREZIONALE BIDIRECTIONAL DOOR



MURATURA
BRICKWALL

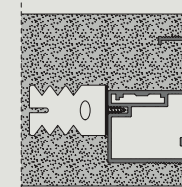

CARTONGESSO
PLASTERBOARD

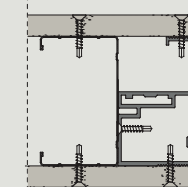

L'apertura bidirezionale, sia a tirare che a spingere, permette un maggior controllo degli ambienti mantenendo il concetto di filomuro.

Bidirectional opening, both pull and push, permits a better control of spaces, keeping the flush to wall concept.

SINGOLA
SINGLE

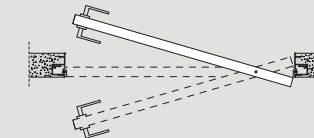

Larghezza fino a 1250 mm
(da 1251 a 1950 a preventivo).
Width up to 1250 mm
(for width from 1251 to 1950
ask for a quotation).



Anta MONO45 B52

B-LICO DOOR

La praticità del sistema di apertura per spazi non convenzionali in due versioni e molteplici rivestimenti.

The convenience of the opening system for not traditional spaces in two versions and various covering.





L'apertura **PRATICA**

un movimento
che riduce l'ingombro.

Practice Opening
a movement reducing
obstructed.

B-Lico B52
L 125 x H 270
RA01 Rovere Antico... Antique Oak



B-Lico B52
 L 125 x H 270
 NC01 Noce Canaletto_American Walnut

Massima LIBERTÀ

finiture e dimensioni per
 grandi aperture.

Maxim Freedom
 finishings and dimensions
 for big opening.



B-Lico B52
 L 140 x H 260
 Carta da parati_Wallpaper



B-Lico allarga gli
 orizzonti della porta
 e apre nuovi spazi.
 In legno, specchio o
 decorato con carta
 da parati, il sistema
 a bilico risolve
 con originalità gli
 ambienti importanti.

B-Lico enlarges
 the door horizons
 and opens new
 spaces. In wood,
 mirror or decorated
 with wallpaper,
 pivot system solves
 all spaces with
 originality.

B-Lico MON045
 L 100 x H 260
 SP01 Specchio Argento_
 Silver Mirror

Apertura SCORREVOLE

SLIDING SYSTEM

Interno muro,
con binario
incassato a
soffitto, con
velette, con ruote
a vista o binario
a scomparsa:
tutte le
possibilità dello
scorrevole, per
ante singole o
doppie.

Inside the wall,
with built-in rail,
with cover profile,
with shown
wheels or with
hidden rail:
all chances of the
sliding system,
for single or
double door.

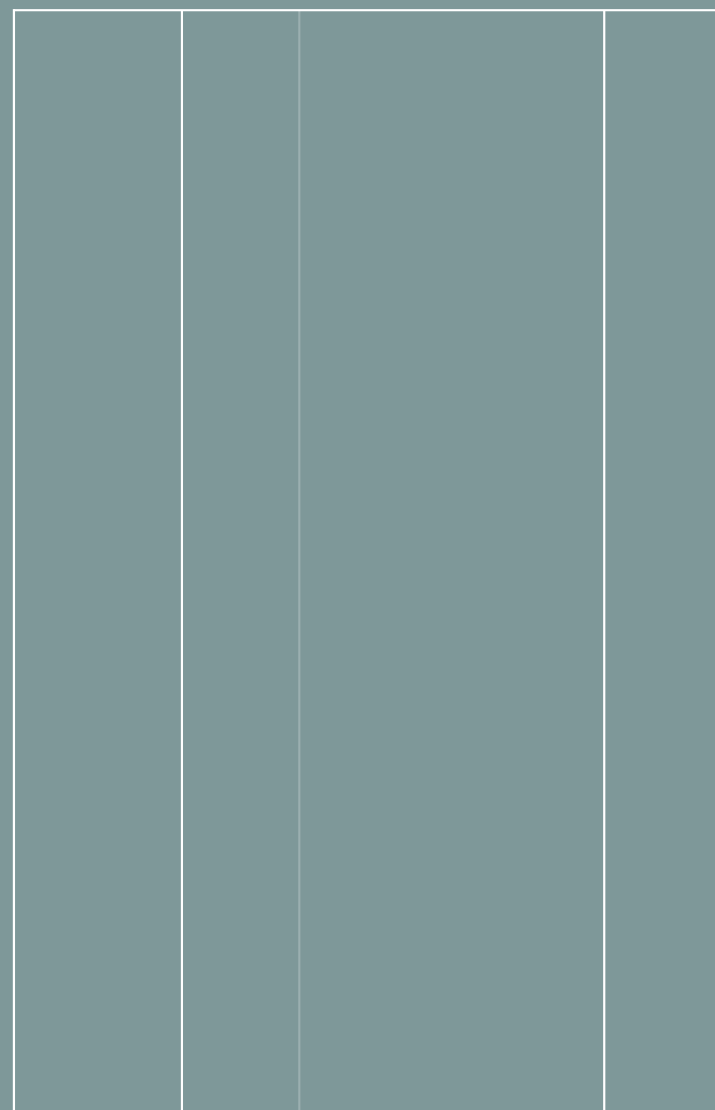

Tanti modi di scorrere
e più tipologie di
ante per una casa
in movimento.

A lot of sliding system
and of doors for an
house in movement.

Binario / Rail

B-MOVE

Sistema di scorrimento /
Sliding System

**SKY
MULTY
MAGIC
BASIC
LUCE-B
LUCE-S
MINIMA**

Anta / Door

**TWIST
PLANA
WALL
DUAL**

Binario / Rail

**VITRUM
MOVE**

Sistema di scorrimento /
Sliding System

**SKY-B
SKY-S
MULTY
MAGIC
BASIC
LUCE-B
LUCE-S
MINIMA**

Anta / Door

PLANA

Binario B-MOVE

MINIMA

Singola o doppia a scomparsa interno muro
Single or double sliding door into the wall

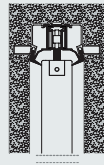

SKY

Singola o doppia con binario incassato a soffitto
Single or double sliding door with built-in rail

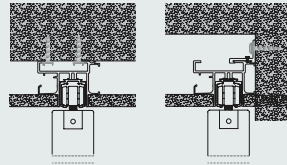
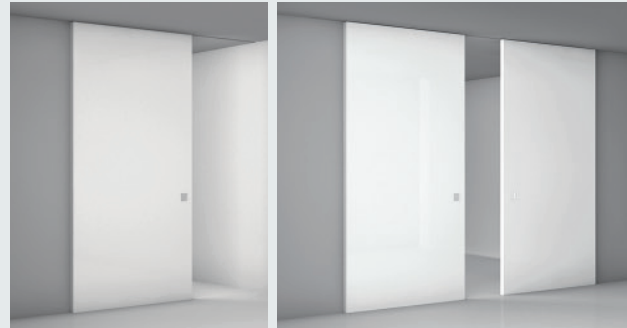

MAGIC

Singola o doppia con binario a scomparsa
Single or double sliding door with hidden rail

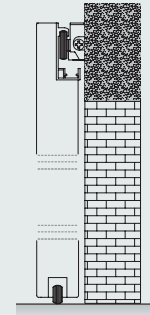

BASIC

Singola o doppia con velette
Single or double sliding door with cover-profile

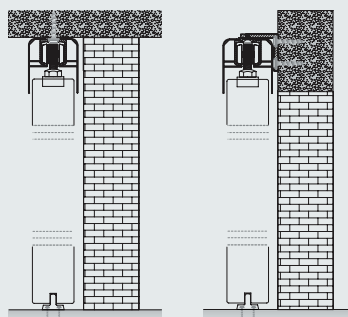

MULTY

Singola o doppia con sistema di scorrimento a ruote
Single or double sliding door with sliding system on wheels

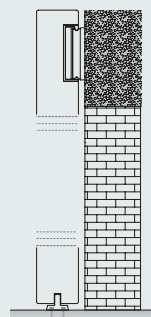

LUCE S

Doppia con binario incassato a soffitto in luce
Double sliding door with built-in rail in the opening

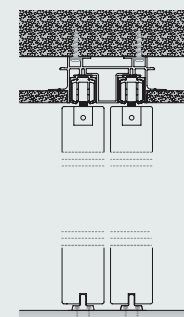

LUCE B

Doppia con velette in luce
Double sliding door with cover-profile into the opening

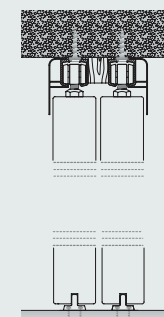

Binario VITRUM-MOVE

MINIMA

Singola o doppia a scomparsa interno muro
Single or double sliding door into the wall

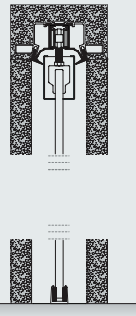

BASIC

Singola o doppia con velette
Single or double sliding door with cover-profile

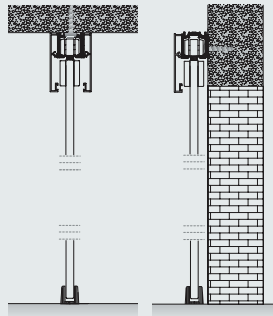
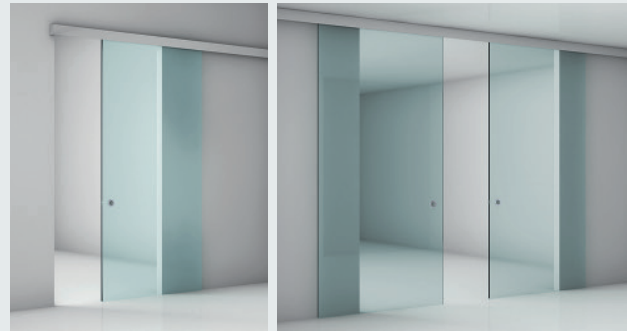

MULTY

Singola o doppia con scorrimento a ruote
Single or double sliding door with sliding system on wheels

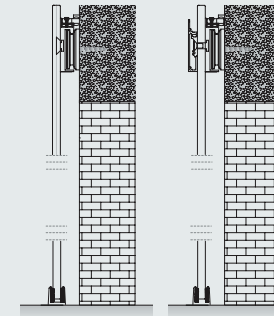

MULTY-80 MULTY-81

MAGIC

Singola o doppia con binario a scomparsa
Single or double sliding door with hidden rail

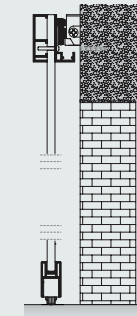

SKY S

Singola o doppia con binario incassato
Single or double sliding door with built-in rail

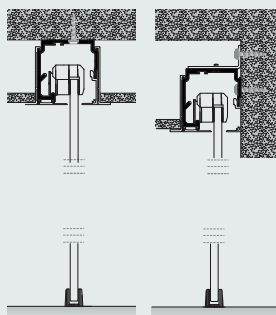
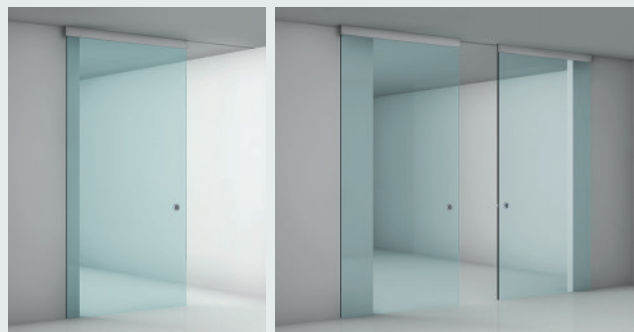

SKY B

Singola o doppia con binario incassato e veletta
Single or double sliding door with built-in rail and cover-profile

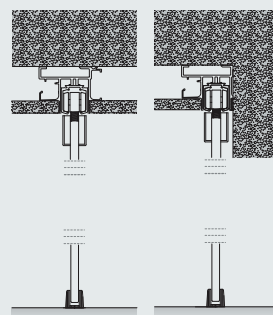
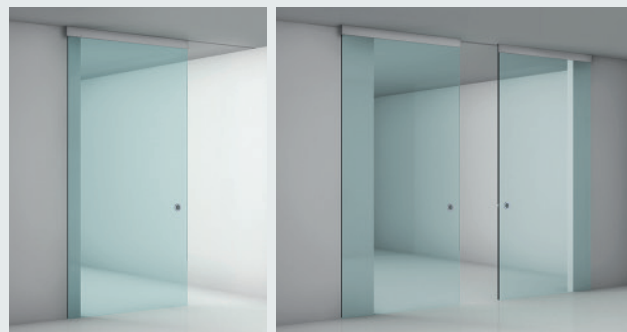

LUCE S

Doppia o singola + fissa binario incassato a soffitto in luce
Double or single + fix sliding door with built-in rail in the opening

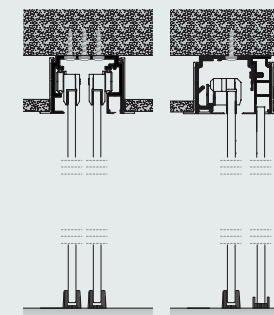
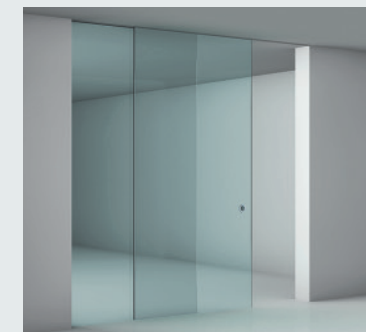

LUCE B

Doppia o singola + fissa con binario in luce con velette
Double or single + fix sliding door with rail in the opening and cover-profile

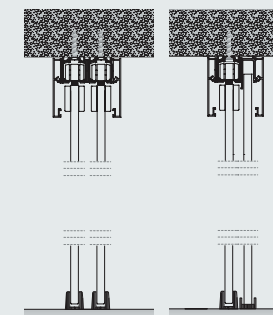
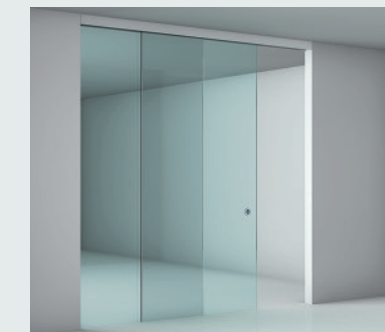



Sistema SKY

SKY SYSTEM

B-Move Sky
L 80 x H 240
RT01 Rovere Tinto Alaska
Alaska Stained Oak

Vitrum-Move Sky-B
L 80 x H 240
VV02 Extrachiaro Satinato
Satin Extraclear Glass



B-Move Sky
L 100 x H 240
Fl60 Alutes Fiori Nero_ Black

Pareti MOBILI

stanze in comunicazione tra di loro.

Moving Wall
room communicating between them.



B-Move Sky
L 90 x H 260
R12 Ecocuoiio Beige_ Eco-leather Beige



Le porte scorrono in guide incassate nel soffitto e aprono gli ambienti con stile. Alutes, ecocuoiio o rovere laccato creano la giusta atmosfera.

Doors slide in built in rail and open spaces with style. Alutes, ecoleather or lacquered oak create the right atmosphere.

B-Move Sky
L 110 x H 270
RL08 Rovere Laccato Cacao_ Chocolate Lacquered Oak

MULTY

Sistema
MULTY

Sistema
MAGIC

MULTY AND
MAGIC SYSTEM

B-Move Multy
L 90+90 x H 220
CR03 Cemento Nebbia_ Cement Fog

MULTY



B-Move Multy
L 100 x H 250
RL05 Frassino Matè Marrone_Matè Ash Brown

MAGIC



B-Move Magic
L 100+100 x H 250
RL02 Rovere Laccato Burro_Butter Lacquered Oak

Un pò di MAGIA

a vista o nascoste,
le ruote scorrono.

A Little Bit of Magic
shown or hidden,
wheels flow.

Multy



Nel sistema Multy
le ruote sono
funzionali e
decorative allo
stesso tempo.

In Multy system
wheels are
functional and
decorative in
the main time.

Magic



Nel sistema Magic
il binario scompare
integrato nell'anta,
ma la funzionalità
rimane immutata.

In Magic system the
rail disappears and it
is integrated on the
door, but the functional
doesn't change.

MAGIC

Progetti di LUCE

la casa è il luogo della creatività.

Projects of Light
the house is
the creativity place.



Vitrum-Move Magic
L 90 x H 240
RAL 5021 Laccato Lucido_Glossy Lacquered

MULTY



Vitrum-Move Multy Digital
L 90 x H 240
Scurochiaro Extrachiaro Trasparente_Transparent Extraclear

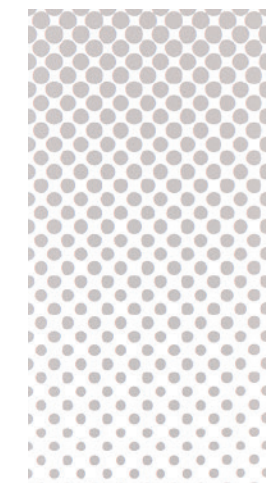

Con lo scorrevole in vetro, la leggerezza è al top. I giochi di trasparenza e la fluidità del movimento diventano protagonisti dell'ambiente.

With the glass sliding door, the light reaches the top. Games of transparency and fluidity of movements become characters of environment.

Sistema BASIC

BASIC SYSTEM





B-Move Basic
L 90 x H 250
FM01 Frassino Matè Bianco_ Matè Ash White

Scorrevole con VELETTE

l'eleganza contemporanea del movimento.

Sliding with Cover profile
Contemporary elegance of the movement

Gli spazi della casa si fanno dinamici.

Spaces of house become dynamic.



Vitrum-Move Basic
L 90 x H 240
Digital Zeronove
VG01 Grigio Trasparente_ Trasparent Grey



Da elemento strutturale, la veletta diventa decorativa e permette alla porta singola o doppia di scorrere sulla parete.

From structural element, the cover profile becomes a decorative element and permits to the single or double door to slide on the wall.

B-Move Basic_Twist
L 100+100 x H 240
L001 Laccato Bianco Opaco/ QD50 Alutes Square Bronzo_ Matt White Lacquered/ Bronzed



Sistema LUCE-B

Sistema LUCE-S

LUCE-B AND
LUCE-S SYSTEM

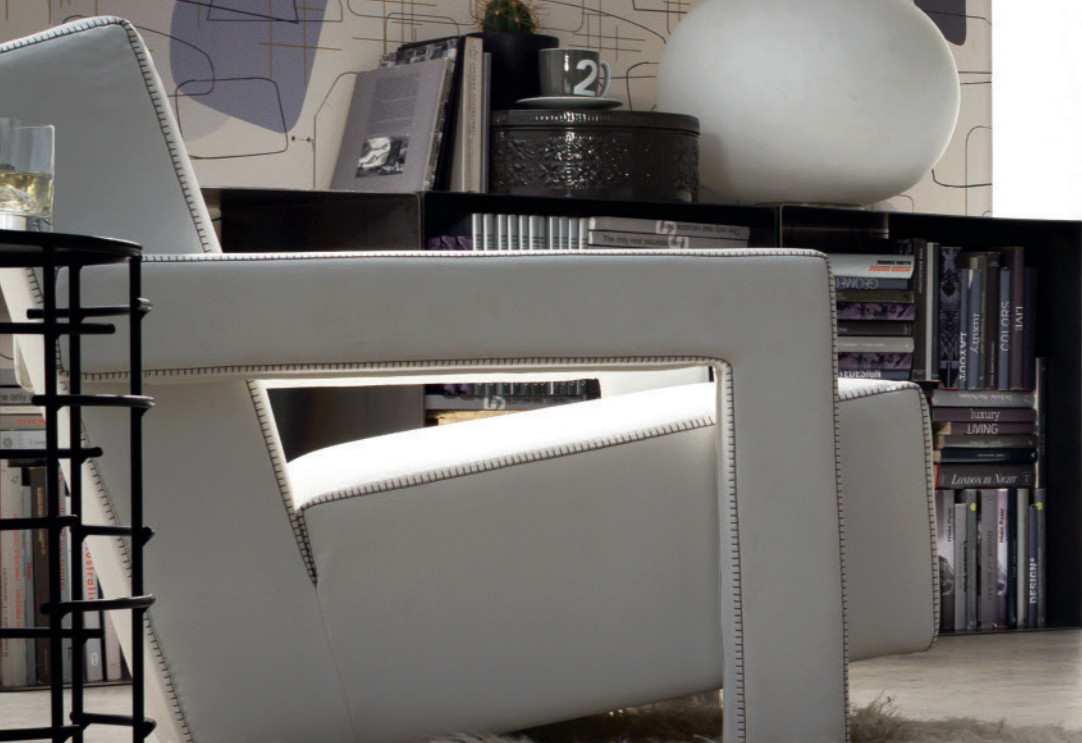

B-Move Luce-S
L 230 x H 270
L003 Laccato Opaco Perla_Matt Pearl Lacquered



B-Move Luce-B
L 320 x H 270
L010 Laccato Opaco Ardesia_ Matt Slate Lacquered

Doppio BINARIO

i pannelli si sovrappongono
e scorrono.

Double Rail
panels overlap and slide.



Vitrum-Move Luce-S
L 220 x H 270
VG01 Grigio Trasparente_ Transparent Grey



Vetri trasparenti
o laccati si
inseriscono
nell'arredo e
ne diventano
parte integrante.
Scelte cromatiche
mettono la porta
in primo piano.

Transparent or
lacquered glasses
insert themselves
into the furniture
becoming part of it.
Chromatic choices
put the door into
the foreground.

B-Move Luce-B
L 230 x H 270
LL01 Laccato Lucido Bianco_
Glossy White Lacquered

▼
Sistema
MINIMA

MINIMA SYSTEM





B-Move Minima
L 120 x H 260
L001 Laccato Opaco Bianco_
Matt White Lacquered



L'apertura non crea
ingombri e lascia
completamente libera
la parete.

The opening doesn't
create obstruction
and leaves the wall
totally free.

B-Move Minima
L 120 x H 270
FM 06Frassino Matè Tabacco_
Matè Ash Tobacco

Interno MURO

un semplice gesto
nasconde la porta.

Inside the Wall
a simple gesture hides
the door.



B-Move Minima
L 80 x H 240
L019 Laccato Fumo_
Smoke Lacquered



Superfici lisce, con
venature o trasparenti:
una varietà di finiture
per porte scorrevoli
salvaspazio.

Smoothly surfaces,
with vein or transparent:
a variety of finishing
for sliding doors
saving space.

Vitrum-Move Minima
L 80 x H 210
VG01 Grigio Trasparente_
Extraclear Grey

Binario QUADRO

QUADRO-MINIMA

Singola o doppia a scomparsa interno muro
Single or double sliding door into the wall

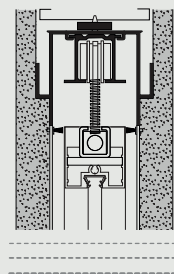

QUADRO-BASIC

Singola o doppia con velette
Single or double sliding door with cover-profile

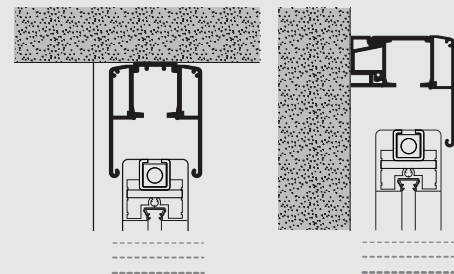
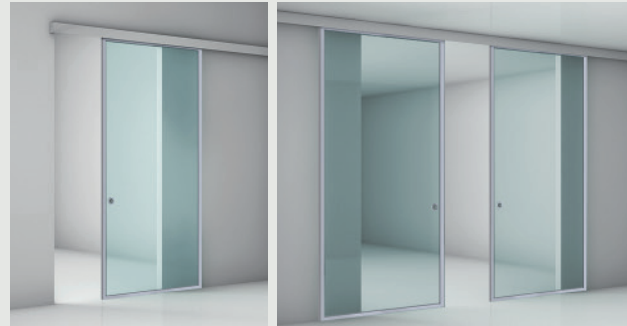

QUADRO-LUCE S

Doppia con binario incassato a soffitto in luce
Double sliding door with built-in rail in the opening

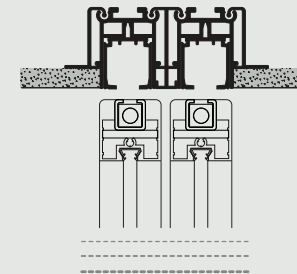
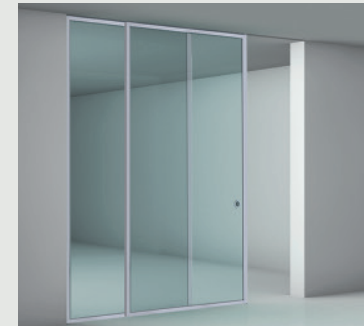

QUADRO-LUCE B

Doppia con binario in luce con velette
Double sliding door with rail in the opening and cover-profile

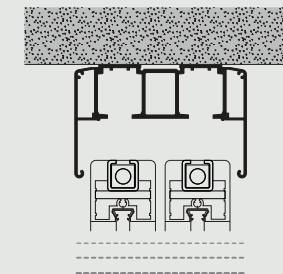
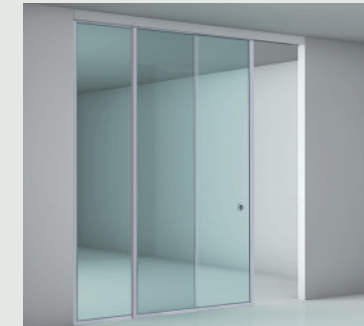

QUADRO-SKY

Singola o doppia con binario incassato a soffitto
Single or double sliding door with built-in rail

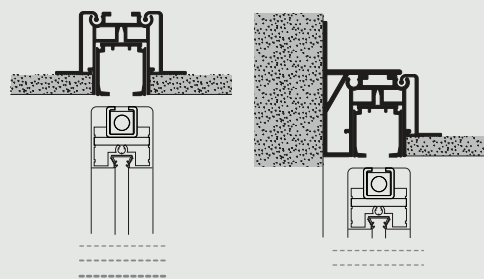

FINITURE SISTEMA QUADRO QUADRO SYSTEM FINISHINGS

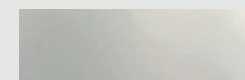

Alluminio Argento_
Silver Aluminium

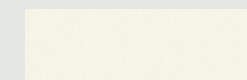

Alluminio Bianco_
White Aluminium



Alluminio Moro_
Dark Brown Aluminium

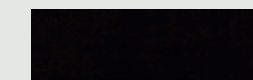

Alluminio Nero_
Black Aluminium

Anta QUADRO

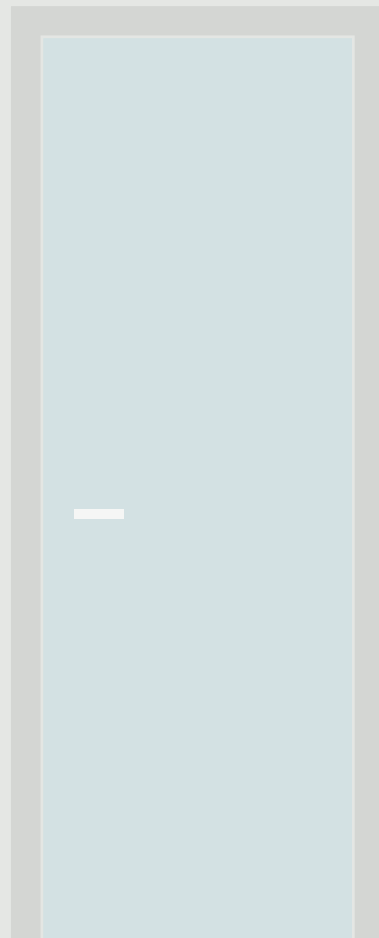

Anta in vetro e profili in alluminio proposti in varie finiture per porte visivamente leggere, ma estremamente funzionali.

Glass door with aluminum profiles, proposed in different finishings for doors which seem light but functional.

CON TRAVERSO
WITH BEAM

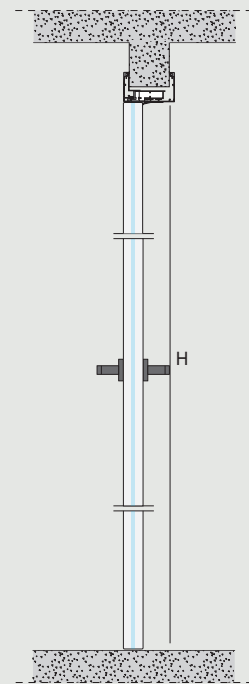

Altezze da 2000 a 2700 mm.
Height from 2000 to 2700 mm.

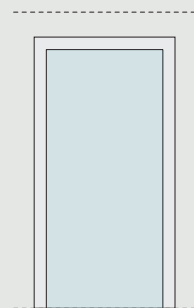

Quadro è disponibile solo con traverso superiore. L'anta in vetro è completamente incorniciata da profili.

Quadro-Line is available with upper beam only. Glass door is completely framed by profiles.

PORTA A TIRARE
PULL DOOR



MURATURA / CARTONGESSO
BRICKWALL / PLASTERBOARD

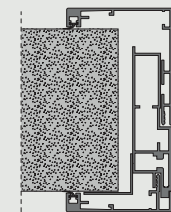

Quadro è disponibile solo per anta singola a tirare. L'apertura verso l'esterno può essere a destra o a sinistra.

Quadro-Line is available for single door with pull opening only. The opening toward the outer side can be right or left.

SINGOLA
SINGLE

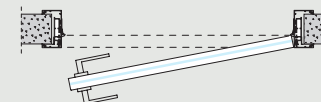

Larghezza da 600 a 1000 mm.
Width from 600 to 1000 mm.

FINITURE SISTEMA QUADRO
QUADRO SYSTEM FINISHINGS

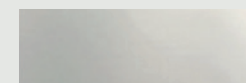

Alluminio Argento_
Silver Aluminium

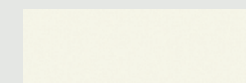

Alluminio Bianco_
White Aluminium



Alluminio Moro_
Dark Brown Aluminium

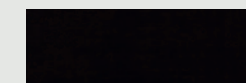

Alluminio Nero_
Black Aluminium

Una perfetta SISTESI

cornici in alluminio
e ante in vetro.

A perfect combination
aluminium profiles
and glass leaves.



Quadro
L 80 x H 220
Alluminio Bianco/Extrachiaro Satinato
White Aluminum/ Satin Extraclear



Quadro
L 450 x H 270
Alluminio Nero/Extrachiaro Trasparente
Black Aluminum/ Transparent Extraclear



Alluminio e vetro per
grandi dimensioni.

Aluminum and glass for
big dimensions.

ANTA QUADRO



Quadro
L 80 x H 240
Alluminio Argento/ Extrachiaro Satinato_
Silver Aluminum/ Satin Extraclear



Quadro
L 80 x H 210
Alluminio Bianco/ Extrachiaro Satinato_
White Aluminum/ Satin Extraclear



Il vetro è incorniciato da un profilo in alluminio, in diverse finiture. La porta mantiene la complanarità anta-telaio e la sua versatilità si adatta a tutti i tipi di interni.

The glass is framed by an aluminum profile, in different finishings. The door keeps the stability door-frame and its versatility is adapt to all interiors.

Quadro
L 80 x H 240
Alluminio Moro/ Extrachiaro Satinato_
Dark Brown Aluminum/ Satin Extraclear

Chiusure SPECIALI

SPECIAL CLOSING

Un sistema per chiudere in maniera semplice e pulita le piccole nicchie, i ripostigli, i quadri elettrici o idraulici in ogni ambiente della casa.

A system for closing in a easy and simple way small niches, storages, switchboards in any part of the house.

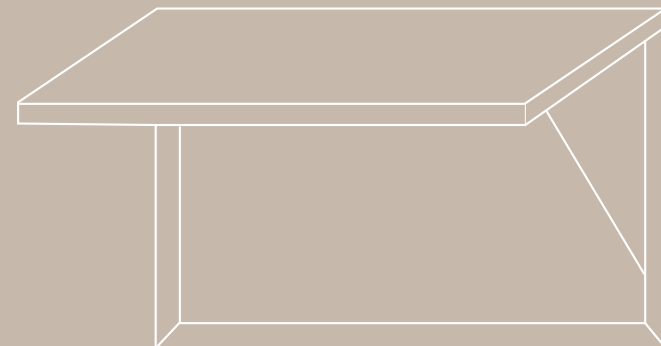

Quattro tipologie di apertura per adattarsi ad ogni esigenza.

Four opening system to be adapted to any request.



Chiusure Speciali / Special Closing

CUBBY

Aperture/ Opening

TIRARE

Pull

RIBALTA

Bottom-Hinged

VASISTAS

Vasistas

BOTOLA

Ceiling Trapdoor



Piccole chiusure **INVISIBILI**

SMALL INVISIBLE CLOSING

Discreti e utili,
tecnici o funzionali:
sono spazi che
animano le pareti,
da chiudere con
ante push-pull o
con chiave.

Discreet and useful,
technical or functional:
there are spaces which
enliven walls, to be
closed with push-pull
closing or with key.



Cubby con
SPECCHIO
Mirrored Cubby



Soluzioni NASCOSTE

da dipingere o rivestire
come la parete.

Hidden Solutions
to be painted or covered
as the wall.

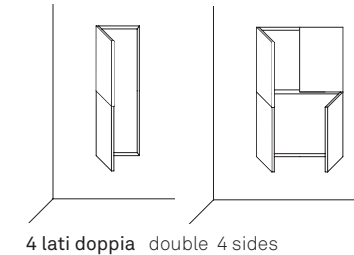
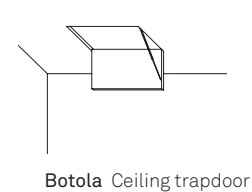
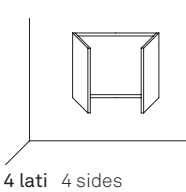
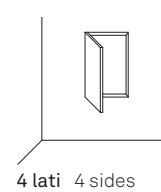
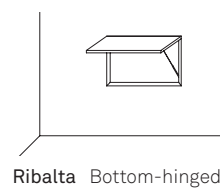
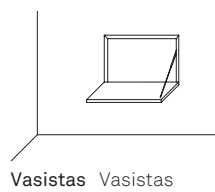
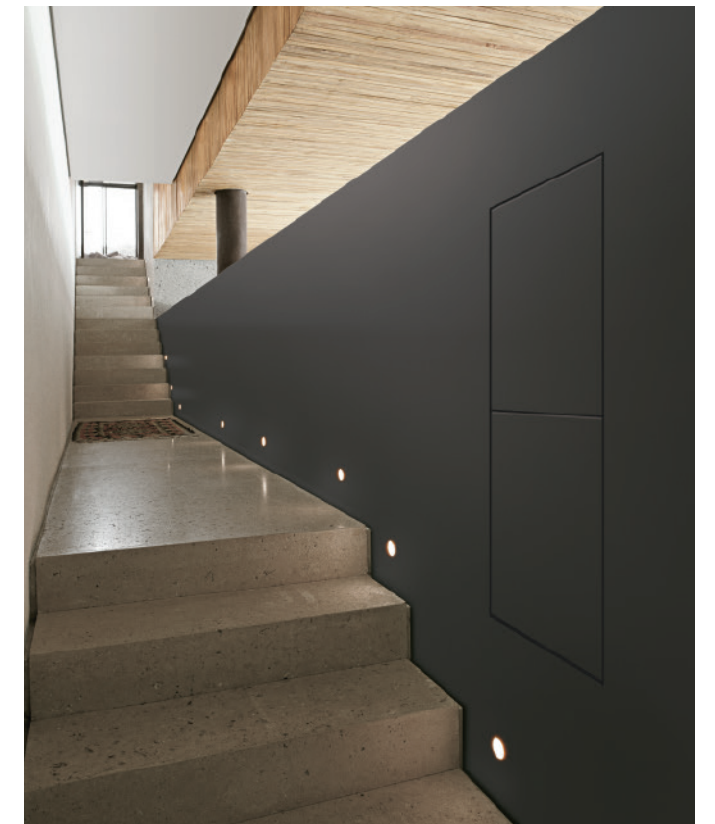
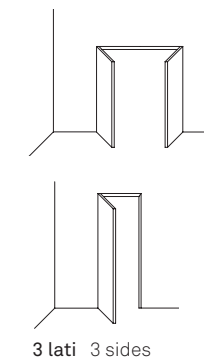



Specifiche TECNICHE

TECHNICAL SPECIFICATION

Legni naturali o laccati,
vetri trasparenti, satinati
o colorati, finiture speciali
e un'ampia scelta di
maniglie: materiali e
dettagli sono importanti
per personalizzare
gli ambienti.

Natural or lacquered
wood, transparent,
satinized or colored
glasses, special
finishings and a wide
range of handles:
materials and details
are important in order to
customize spaces.

TELAIO B-LINE

B-LINE FRAME

Questo innovativo telaio a raso muro è qualificato da una importante sezione in alluminio che assicura rigidità, resistenza meccanica e ne facilita l'installazione.

The original flush to wall frame is typical of an important aluminum section. This section guarantees rigidity, strength and facilitates the assembling.

TELAIO A SPINGERE PUSH FRAME



Profilo del telaio a doppia camera per attenuare ogni tipo di vibrazione.

Frame profiles with two cells, in order to avoid vibrations.

Guarnizione in schiuma per mantenere inalterate nel tempo le sue prestazioni.

Foam trim in order to ensure long lasting.

Fondino della cerniera preinstallato nel telaio.

Bottom of the hinge integrated into the frame.

TELAIO A TIRARE PULL FRAME



Profilo di compensazione fornito nella dotazione standard.

Given balance profile.

Sezione esterna del telaio progettata per facilitare e rendere veloce le fasi di installazione.

External frame section built in order to facilitate and accelerate the assembling.

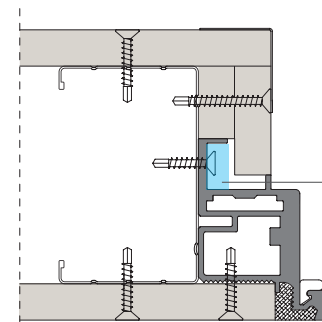

B-Line con apertura a spingere
B-Line with push opening.

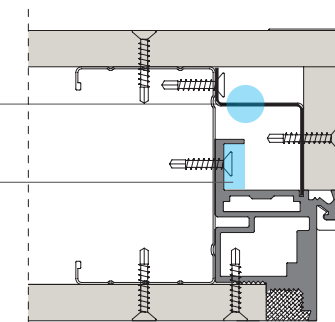

B-Line con apertura a tirare.
B-Line with pull opening.

TAMBURATO

HOLLOW CORE

Costruzione della porta in pannello tamburato leggero e resistente adatto a mantenere nel tempo planarità ed evitare deformazioni della superficie.

Structure of the door in light and resistant hollow core panel. The panel is adapt to keep the stability during time and to avoid surfaces contortion.

Intelaiatura del tamburato in doppio massello di abete.

Hollow core structure in a double fir layer

Carta alveolare a nido d'ape con celle da 14 mm.

14 mm honey comb.

Cartelle esterne in MDF con spessore 5 mm.

5 mm MDF external layer.

Bordo in legno con spessore 20/10 su 4 lati.

Wooden 20/10 edge on 4 sides.



ZANCA WALTIE

La forma ed il sistema di aggancio delle zanche sono stati progettati per permettere una regolazione efficace in altezza, una sufficiente rotazione laterale ed una facile piegatura.

The shape and the fixing system of walties have been made in order to permit an easy regulation in height and curving and easy turning.

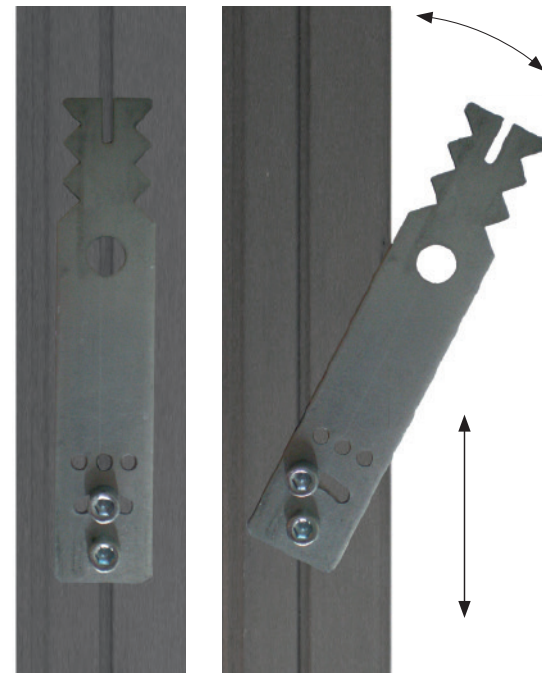

Zanca regolabile in altezza e profondità.
The waltie is adjustable in height and depth.

QUOTA ZERO-QUOTA 100 ZERO LEVEL-100 LEVEL

Il telaio assemblato riporta due adesivi che indicano la quota zero pavimento finito e la quota 100 cm per essere installato correttamente.

The assembled frame has 2 stickers: finished floor Zero level and 100 level, in order to be assembled in the right way.

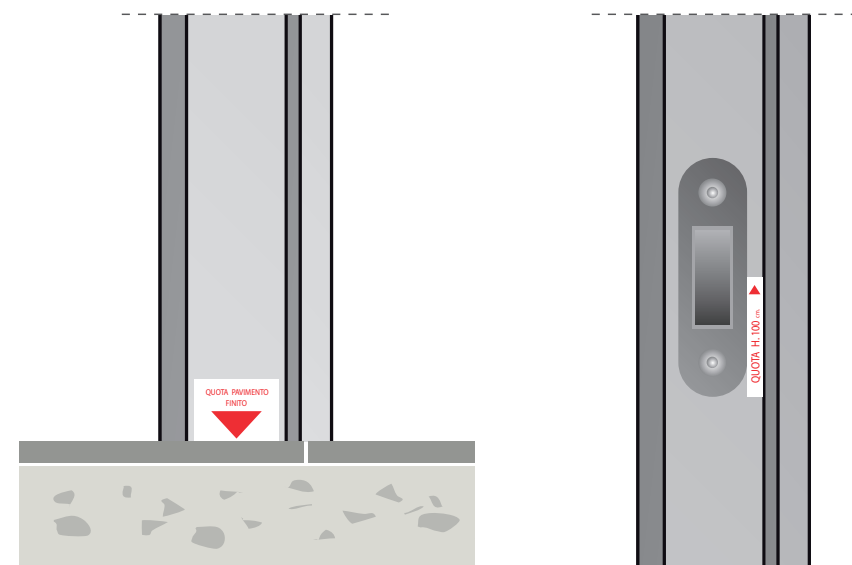

Quota Zero
Zero Level

Quota 100
100 Level

PANNELLO FONOASSORBENTE SOUNDPROOF TUBULAR

Fabbricazione della porta impiegando un pannello fono isolante in truciolare tubolare per ottenere un opportuno isolamento acustico.

Door made using a soundproof tubular chipboard in order to obtain noise insulation.

Truciolare tubolare fonoassorbente.
Soundproof tubular chipboard.

Paraspifferi automatico per taglio termico e acustico.
Draught stopper for noise and heat.

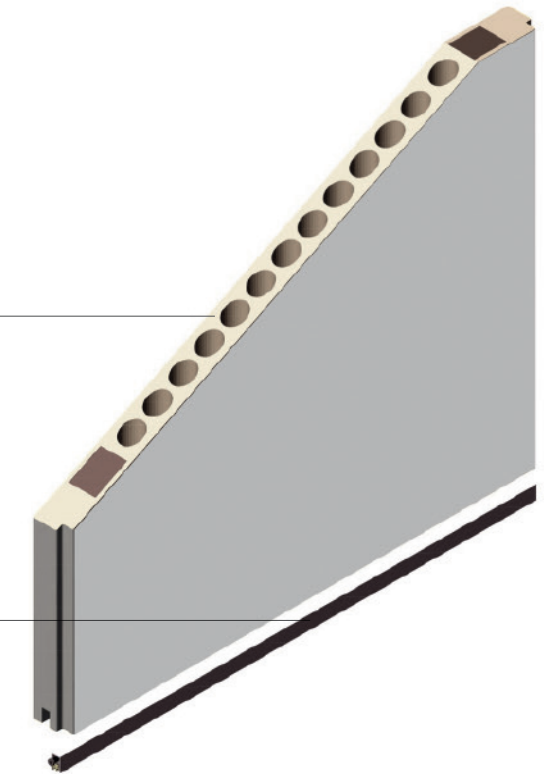

TENDITORE RADDRIZZANTE STRAIGHTEN

Tenditore interno registrabile inserito su tutte le porte con doppia finitura o con altezza superiore a 2700 mm.

Straighten put on all doors with double finishing or higher than 2700 mm.

Chiave di regolazione
Regulating key.

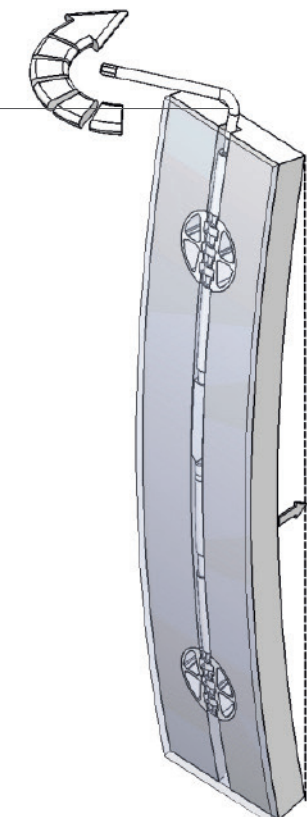

BOISERIE

BOISERIE

Boiserie è un sistema per il rivestimento delle pareti realizzato con pannelli in multistrati di okoumé. Si integra perfettamente con il telaio raso muro B-Line e consente di avere una totale complanarità tra porta e boiserie.

E' proposta in 2 versioni: Boiserie -V con pannelli in verticale e Boiserie-H con pannelli in orizzontale.

Boiserie is a wall covering system made by panels in okoumé multilayer. It perfectly matches itself with the flush to wall frame B-Line and permits to have a fully complanarity between door and boiserie.

It exists in 2 versions: Boiserie - V with vertical panels and Boiserie - H with horizontal panels.



Pannello di chiusura bordato.
Edged closing panel.

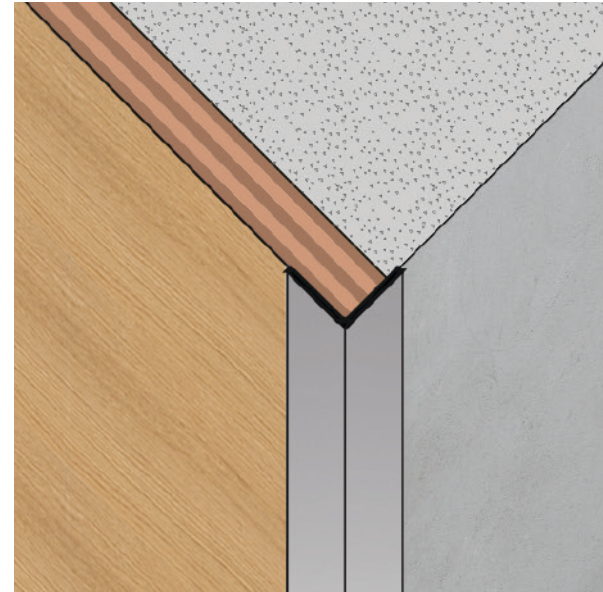

Profilo in alluminio laccato o in tinta per chiusura terminale.

Matched or lacquered aluminum profile for closing.

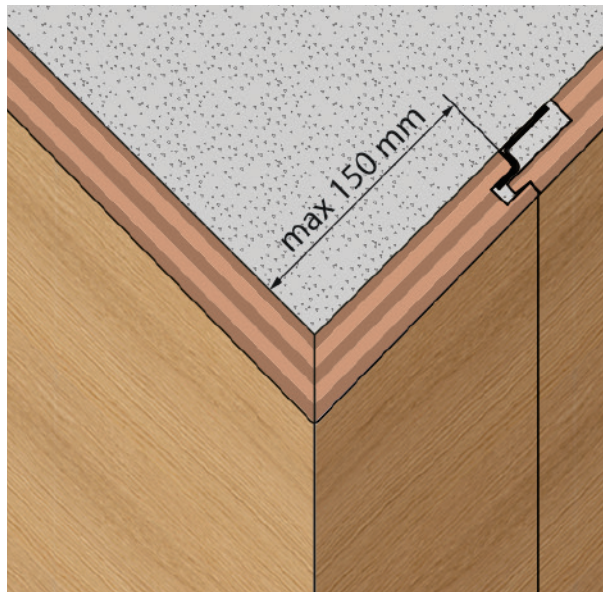

Pannello assemblato a 45° con un lato di dimensione max 150 mm.

45° assembled panel with one side maximum dimension 150 mm.

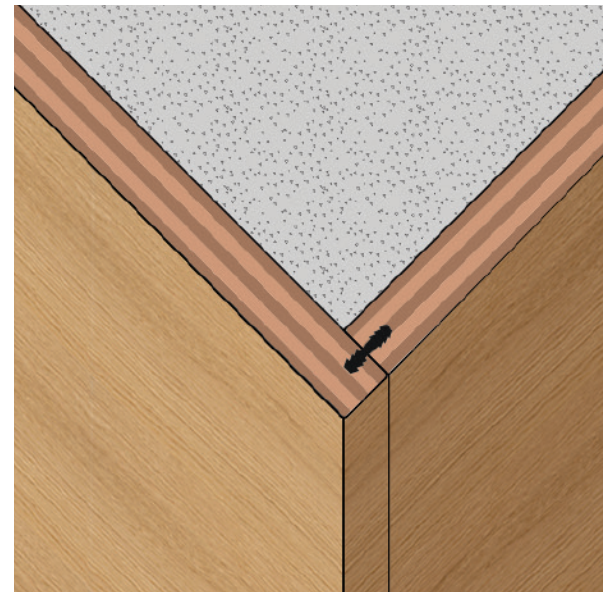

Pannello assemblato a 90°.

90° assembled panel.

BOISERIE VERTICALE

VERTICAL BOISERIE



Installazione pannello iniziale Boiserie-V.

Installation of the starting panel Boiserie-V.

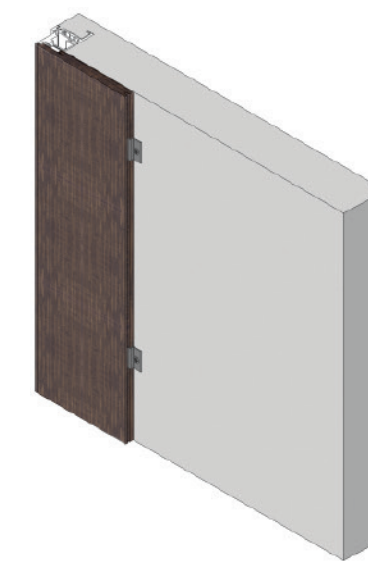

Ancoraggio pannello iniziale Boiserie-V.

Anchor of the starting panel Boiserie-V.



Installazione pannelli successivi Boiserie-V.

Installation of following panels Boiserie-V.

BOISERIE ORIZZONTALE

HORIZONTAL BOISERIE

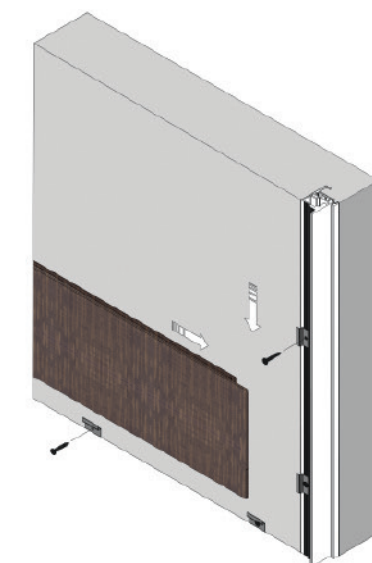

Installazione pannello iniziale Boiserie-H.

Installation of the starting panel Boiserie-H.

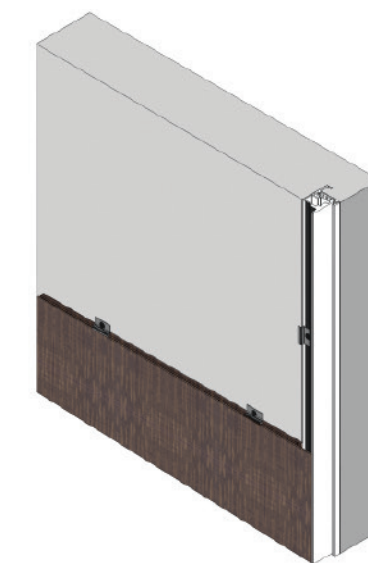

Ancoraggio pannello iniziale Boiserie-H.

Anchor of the starting panel Boiserie-H.

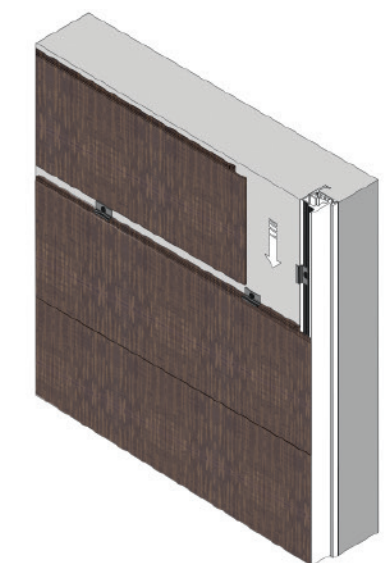

Installazione pannelli successivi Boiserie-H.

Installation of following panels Boiserie-H.

MANIGLIE PER PORTE BATTENTI

HANDLES - SWING DOORS



Chiusura solo Maniglia
Handle Only



Chiusura Chiave
Key Lock



Chiusura Nottolino
Latch lock



Chiusura Yale
Yale Lock

► FLUÒ



FL 12 OC
Cromo Lucido
Glossy Chrome



FL 12 OCS
Cromo Satinato
Chrome Satin



FL 12 OLV
Ottone Lucido
Glossy Brass



RDN 12
Nottolino LOGO 12
LOGO 12 latch

► LUCE



LC 12 OC
Cromo Lucido
Glossy Chrome



LC 12 OCS
Cromo Satinato
Chrome Satin



LC 12 OLV
Ottone Lucido
Glossy Brass



LC 12 ZGH
Bronzo Satinato
Bronzed Satin



RDN 12
Nottolino LOGO 12
LOGO 12 latch

► EDRA



ED 41 OC
Cromo Lucido
Glossy Chrome



ED 41 OCS
Cromo Satinato
Chrome Satin



RDN 41
Nottolino LOGO 41
LOGO 41 latch

► CHIC



SC 41 OC
Cromo Lucido
Glossy Chrome



SC 41 OCS
Cromo Satinato
Chrome Satin

Maniglia con fondino abbinato
alla finitura della porta
Handle with bottom matching
the door finishing



RDN 41
Nottolino LOGO 41
LOGO 41 latch

► JOY



JO 12 OC
Cromo Lucido
Glossy Chrome



JO 12 OCS
Cromo Satinato
Chrome Satin



RDN 14
Nottolino LOGO 14
LOGO 14 latch

► ESA



ES 14 BCI
Cromo - Bianco
Chrome - White



ES 14 CCS
Cromo - Satinato
Chrome - Satin



ES 14 CNE
Cromo - Nero
Chrome - Black



RDN 14
Nottolino LOGO 14
LOGO 14 latch

► HOLLY



HO 14 OC
Cromo Lucido
Glossy Chrome



HO 14 OCS
Cromo Satinato
Chrome Satin



HO 14 AB
Bronzato
Bronzed



RDN 14
Nottolino LOGO 14
LOGO 14 latch



HO 14 ZBN
Bianco
White



HO 14 ZNE
Nero
Black

POMOLO PER PORTE BATTENTI

KNOB - SWING DOORS

► RING



RI 35 OC
Cromo Lucido
Glossy Chrome



RI 35 OCS
Cromo Satinato
Chrome Satin



RDN 14
Nottolino LOGO 14
LOGO 14 latch

MANIGLIE PER PORTE BATTENTI A VETRO

HANDLES - SWING DOORS - GLASS DOORS

► V750



Serratura con nottolino
Lock with latch

Cromo Lucido
Glossy Chrome

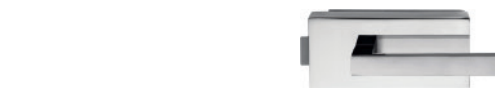

Serratura senza chiave
Lock without key

Cromo Satinato
Chrome Satin

► R 10



Il modello R10 è disponibile:
R10 handle is available:

Ø25x300
Ø25x650
Ø30x1000

Inox Satinato
Satin stainless steel

MANIGLIE PER PORTE SCORREVOLI

HANDLES - SLIDING DOORS

► S-68



Maniglia
Handle



Maniglia con fondino abbinato alla finitura della porta
Handle with bottom matching the door finishing

► RONDÒ T-48



SD 202

Maniglia
Handle

■ Cromo Lucido
Glossy Chrome



SD 205

Maniglia + chiave
Handle + key

■ Cromo Satinato
Chrome Satin



SD 204

Maniglia + nottolino
Handle + latch

■ Ottone Lucido
Glossy Brass

► RING Q-65



SD 222

Maniglia
Handle

■ Cromo Lucido
Glossy Chrome



SD 223

Maniglia + chiave
Handle + key

■ Cromo Satinato
Chrome Satin



SD 224

Maniglia + nottolino
Handle + latch

► C-09



La maniglia C-09 può essere utilizzata anche su porte B-Line a libro, con chiusura Push-Pull o con serratura a rullo.

Handle C-09 can be installed on B-Line folding doors, with Push-Pull or roller lock

Maniglia
Handle

■ Cromo Satinato
Chrome Satin

MANIGLIE PER PORTE SCORREVOLI A VETRO

HANDLES - SLIDING DOORS - GLASS DOORS

► V-019



Vetro Trasparente Satinato e base Nichel Satinato
Transparent satin glass and base Satinized Nickel

► B-168



■ Cromo Lucido
Glossy Chrome

■ Nichel Satinato
Satinized Nickel

► V-407 WC-PO



■ Cromo Lucido
Glossy Chrome

■ Nichel Satinato
Satinized Nickel

► V-406



■ Cromo Lucido
Glossy Chrome

■ Nichel Satinato
Satinized Nickel

► V-511



■ Cromo Lucido
Glossy Chrome

■ Cromo Satinato
Chrome Satin

■ Nichel Satinato
Satinized Nickel

■ Ottone Lucido
Glossy Brass

► R-10



Il modello R10 è disponibile:
R10 handle is available:

Ø25x300
Ø25x650
Ø30x1000

■ Inox Satinato
Satin stainless steel

► V-524



■ Cromo Lucido
Glossy Chrome

■ Alluminio Anodizzato
Anodized Aluminium

■ Nichel Satinato
Satinized Nickel

► V-522



■ Cromo Lucido
Glossy Chrome

■ Nichel Satinato
Satinized Nickel

MANIGLIE PER PORTE SCORREVOLE QUADRO

HANDLES - SLIDING DOORS - QUADRO DOORS

► CLIP



► DADO



► DADO CON SERRATURA_WITH LOOK



■ Alluminio Argento
Silver Aluminium

■ Alluminio Bianco
White Aluminium

■ Alluminio Moro
Dark Brown Aluminium

■ Alluminio Nero
Black Aluminium

FINITURE SPECIALI

SPECIAL FINISHING



ALUTES Silk SK10 Argento_ Silver SK10



ALUTES Silk SK20 Oro_ Gold SK20



ALUTES Square QD10 Argento_ Silver QD10



ALUTES Square QD15 Nichel_ Nichel QD15



ALUTES Square QD20 Oro_ Gold QD20



ALUTES Square QD30 Rame_ Copper QD30



ALUTES Square QD40 Acciaio_ Steel QD40

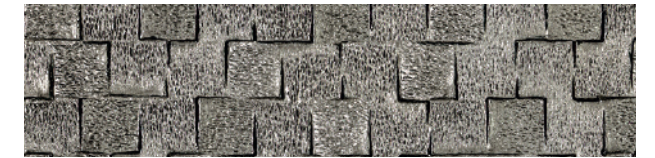

ALUTES Square QD45 Titanio_ Titanium QD45



ALUTES Square QD50 Bronzo_ Bronze QD50



ALUTES Square QD60 Nero_ Black QD60

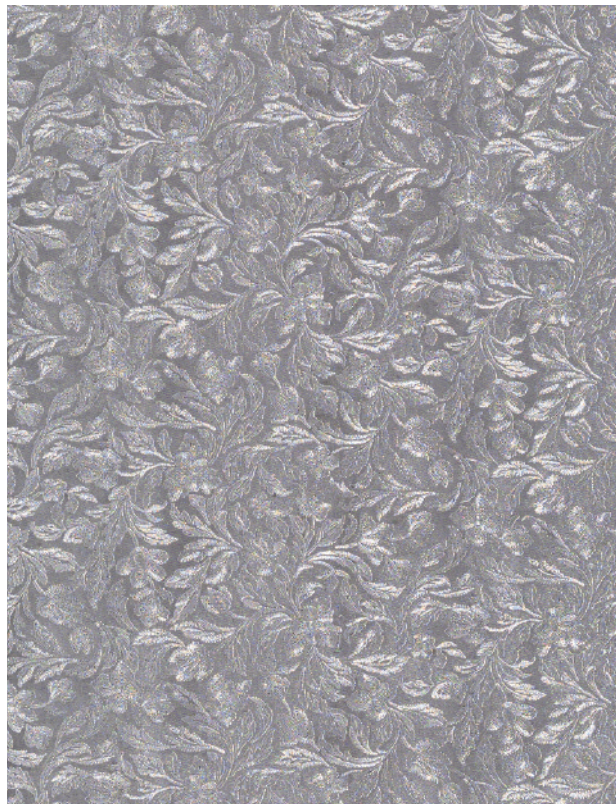

ALUTES Fiori FI10 Argento_ Silver FI10

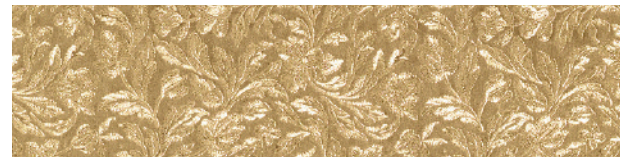

ALUTES Fiori FI20 Oro_ Gold FI20

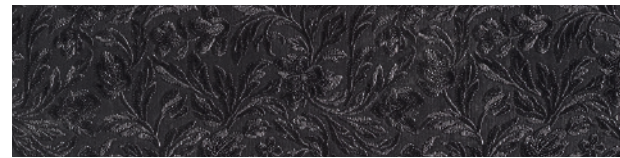

ALUTES Fiori FI60 Nero_ Black FI60

FINITURE SPECIALI

SPECIAL FINISHING

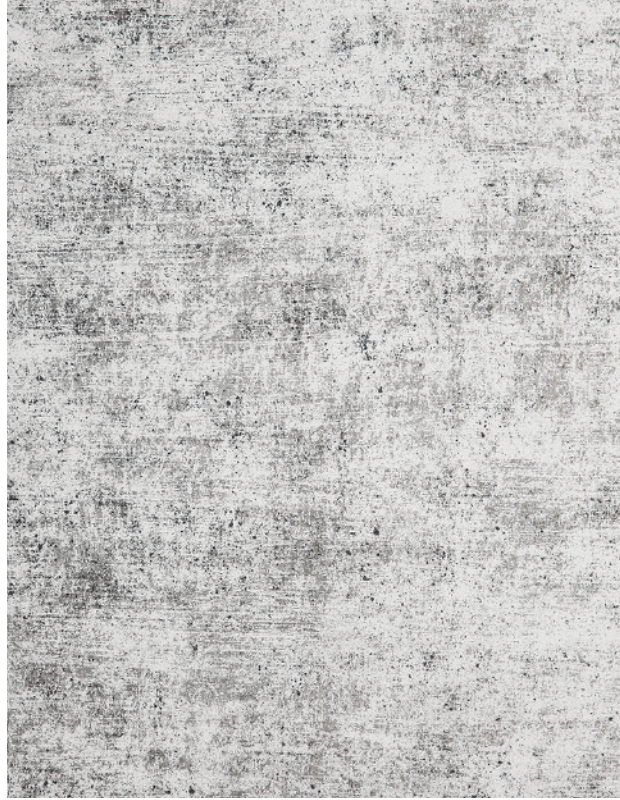

SPECCHIO Antico Argento SA11_Antique Silver Mirror SA11



SPECCHIO Antico Oro SA12_Antique Gold Mirror SA12



IMPACT Bronze SL01



IMPACT Silver SL02



PIETRA multicolor PM01_Multicolor Stone PM01



PIETRA Shine PS01_Shine Stone PS01

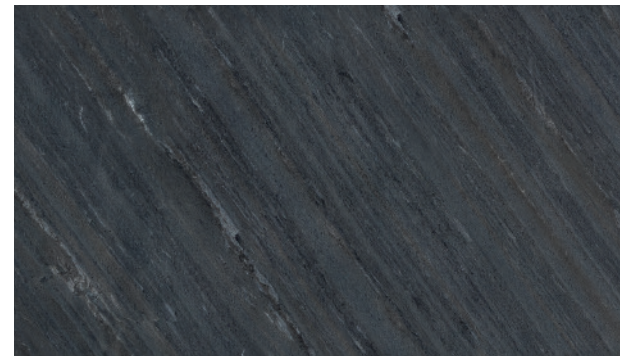

PIETRA Ocean P001_Ocean Stone P001



VINTAGE Copper SL03



Opal SG01

FINITURE SPECIALI

SPECIAL FINISHING



CEMENTO Neve CR01_Cement Snow CR01



Cemento Ghiaccio CR02_Cement Ice CR02

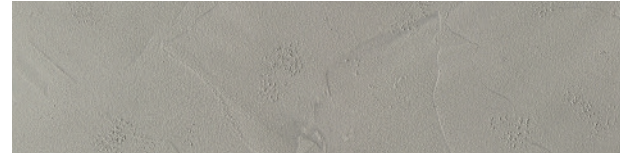

Cemento Nebbia CR03_Cement Fog CR03



CEMENTO Corten CR04_Cement Corten CR04



ECOCUOIO Testa di Moro R07_Eco-leather Dark Brown R07

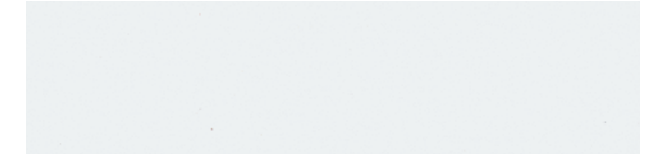

ECOCUOIO Bianco R01_Eco-leather White R01



ECOCUOIO Beige R12_Eco-leather Beige R12



ECOCUOIO Marrone R03_Eco-leather Brown R03



ECOCUOIO Rosso R04_Eco-leather Red R04



ECOCUOIO Grigio R05_Eco-leather Grey R05



ECOCUOIO Blu R06_Eco-leather Blue R06



ECOCUOIO Bordeaux R10_Eco-leather Bordeaux R10



ECOCUOIO Nero R08_Eco-leather Black R08

LEGNI

WOOD

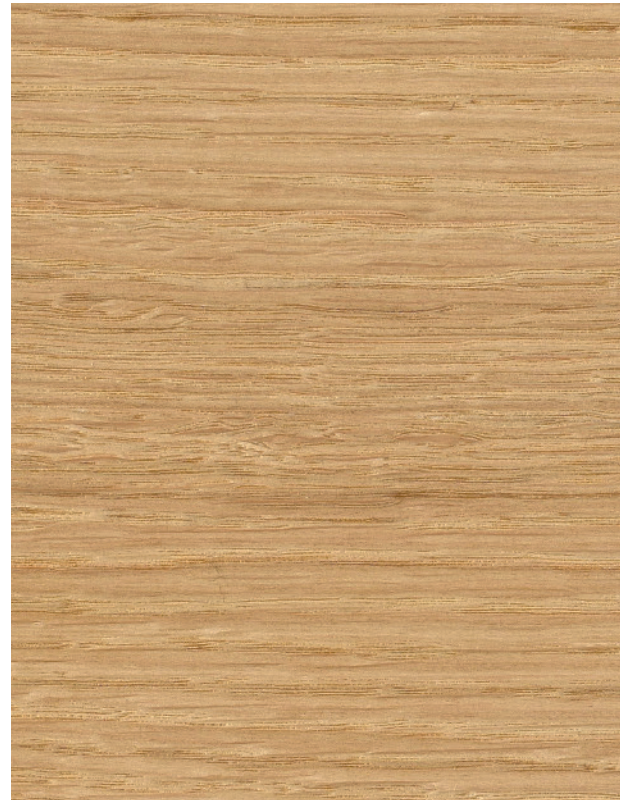

ROVERE Naturale RN01_ Natural Oak RN01



ROVERE Tinto Moka RT04_ Moka Stained Oak RT04

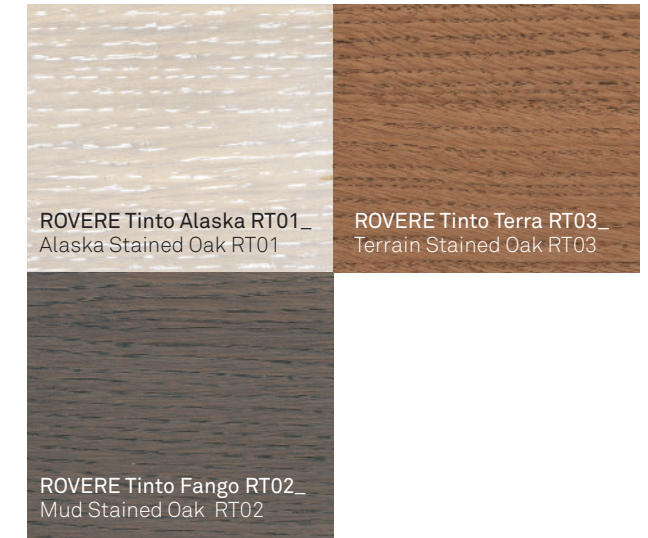

ROVERE Tinto Alaska RT01_ Alaska Stained Oak RT01

ROVERE Tinto Terra RT03_ Terrain Stained Oak RT03

ROVERE Tinto Fango RT02_ Mud Stained Oak RT02



ROVERE Antico Naturale RA01_ Antique Natural Oak RA01



ROVERE Antico Grigio RA02_ Antique Grey Oak RA02



ROVERE LACCATO Bianco RL01_ White Lacquered Oak RL01



Burro RL02 Butter RL02

Canapa RL15 Hemp RL15

Fumo RL19 Smoke RL19

Perla RL03 Pearl RL03

Rubino RL06 Ruby RL06

Ardesia RL10 Slate RL10

Crema RL04 Cream RL04

Caffè RL07 Coffee RL07

Cobalto RL11 Blue RL11

Cacao RL08 Chocolate RL08

Nero RL12 Black RL12

LEGNI

WOOD



NOCE Canaletto NC01_ American Walnut NC01



FRASSINO MATÈ Tabacco FM06_Matè Ash Tabacco FM06

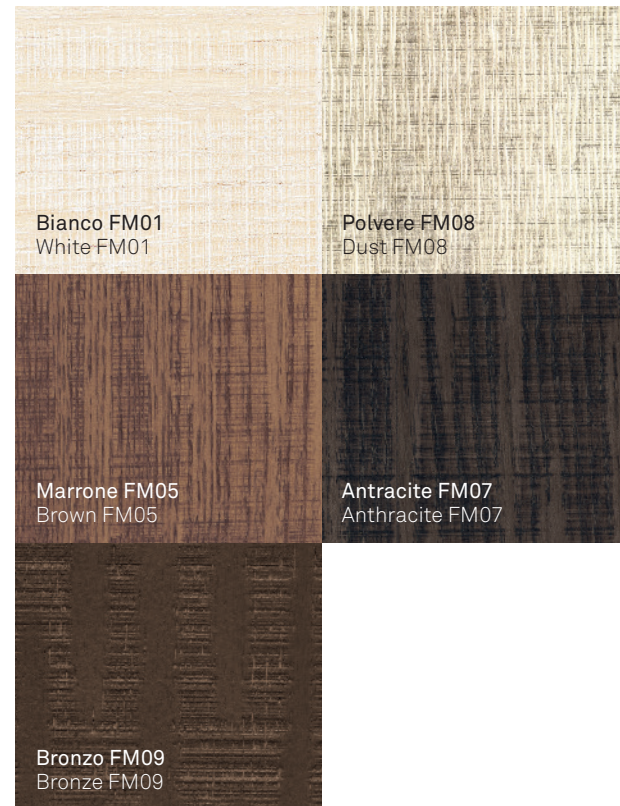

LACCATI OPACHI/LUCIDI

MATT/GLOSSY LACQUERS

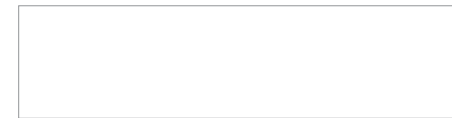

Bianco 01_ White 01

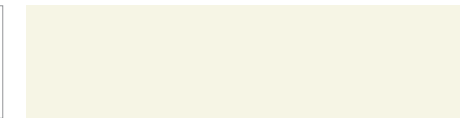

Burro 02_ Butter 02



Perla 03_ Pearl 03



Crema 04_ Cream 04



Canapa 15_ Hemp 15



Caffè 07_ Coffee 07



Fumo 19_ Smoke 19



Ardesia 10_ Slate 10



Cacao 08_ Chocolate 08



Rubino 06_ Ruby 06



Cobalto 11_ Blue 11



Nero 12_ Black 12



VETRI LACCATI

LACQUERED GLASS



Bianco VL01_ White VL01



Burro VL02_ Butter VL02



Perla VL03_ Pearl VL03



Crema VL04_ Cream VL04



Canapa VL15_ Hemp VL15



Caffè VL07_ Coffee VL07



Fumo VL19_ Smoke VL19



Ardesia VL10_ Slate VL10



Cacao VL08_ Chocolate VL08



Rubino VL06_ Ruby VL06



Cobalto VL11_ Blue VL11



Nero VL12_ Black VL12



VETRI

GLASS



VV02 Extrachiaro Satinato
Satin Extraclear

VV01 Extrachiaro Trasparente
Transparent Extraclear

VG02 Grigio Satinato
Satin Smoked

VG01 Grigio Trasparente
Transparent Smoked

VB02 Bronzo Satinato
Satin Bronzed

VB01 Bronzo Trasparente
Transparent Bronzed

VETRI TEXTURE

TEXTURE GLASS

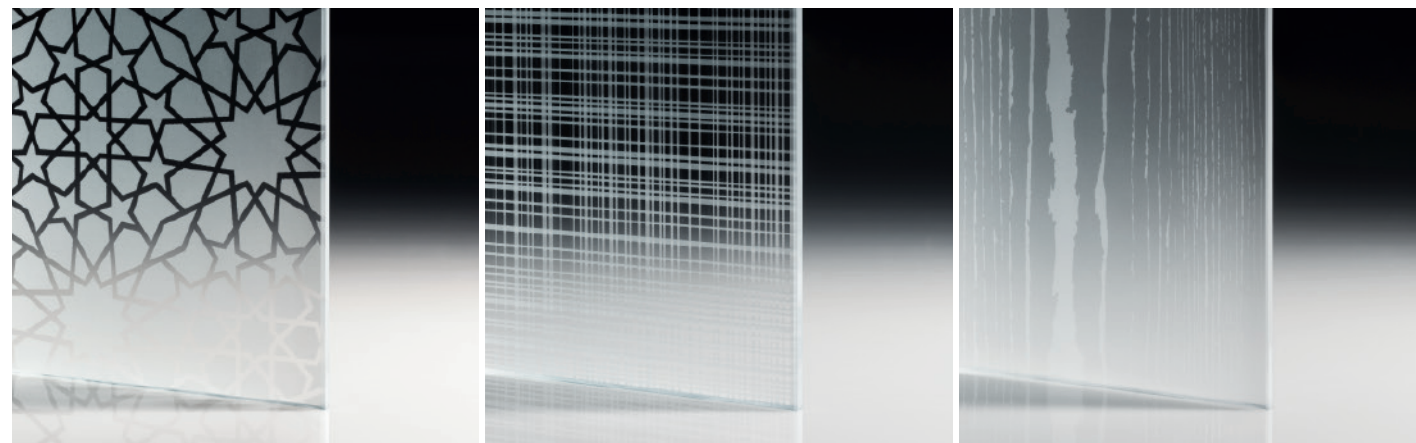

V001 Vetro Marrakech_ Marrakech Glass

V002 Vetro Manhattan_ Manhattan Glass

V003 Vetro Ontario_ Ontario Glass

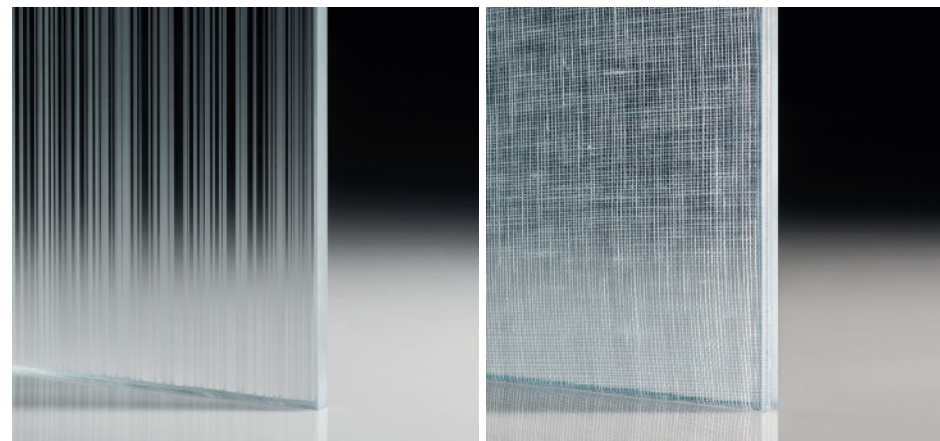

V004 Vetro Nevada_ Nevada Glass

VT01 Vetro Shape_ Shape Glass

CERNIERE VITRUM

VITRUM HINGES

CERNIERA P-08
HINGE P-08



Con la cerniera P-08 si possono utilizzare i seguenti vetri:

- Extrachiaro trasparente-satinato
- Grigio trasparente-satinato
- Bronzo trasparente-satinato
- Vetri Decor
- Vetri Digital

Following glasses can be used with P-08 hinge:

- Transparent - Satin Extraclear
- Transparent - Satin Smoked
- Transparent - Satin Bronzed
- Decor Glass
- Digital Glass

CERNIERA V-719
HINGE V-719



Con la cerniera V-719 si possono utilizzare i seguenti vetri:

- Extrachiaro trasparente-satinato
- Grigio trasparente-satinato
- Bronzo trasparente-satinato
- Vetri Decor
- Vetri Digital
- Vetri Texture

Following glasses can be used with V-719 hinge:

- Transparent - Satin Extraclear
- Transparent - Satin Smoked
- Transparent - Satin Bronzed
- Decor Glass
- Digital Glass
- Texture Glass

PROFILO QUADRO

QUADRO PROFILE

CORNICE IN ALLUMINIO DA MM 15X40
ALUMINIUM FRAME MM 15X40



Con la cornice in alluminio Quadro si possono utilizzare i seguenti vetri:

- Extrachiaro trasparente e satinato
- Grigio trasparente e satinato
- Bronzo trasparente e satinato

Following glasses can be used with Quadro aluminium frame:

- Transparent - Satin Extraclear
- Transparent - Satin Smoked
- Transparent - Satin Bronzed

VITRUM DIGITAL

VITRUM DIGITAL



Spazio



Zeronove

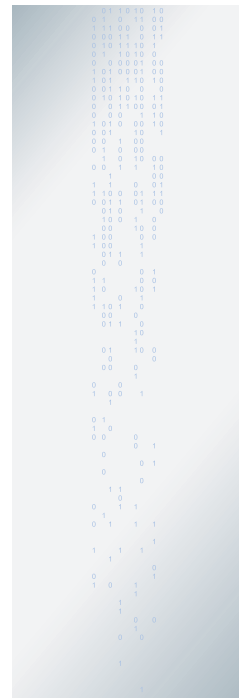

Zerouno

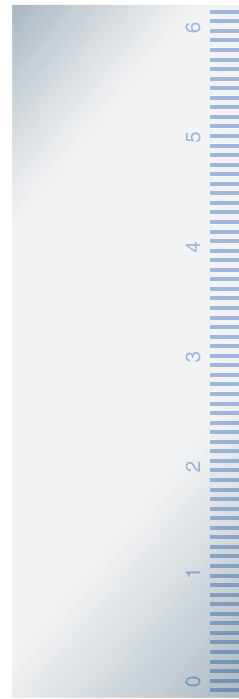

Zerosei



Scurochiaro

VITRUM DECOR

VITRUM DECOR



Opera



Idea



Danza

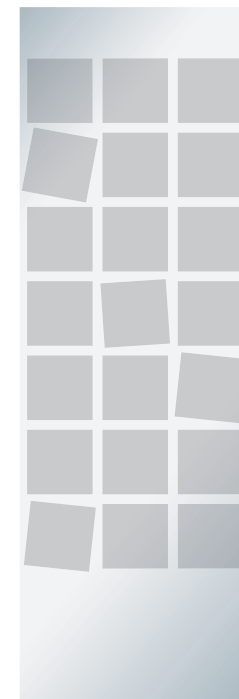

Disordine

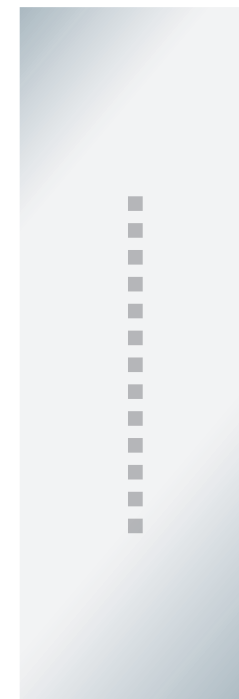

Ordine



Zeromille

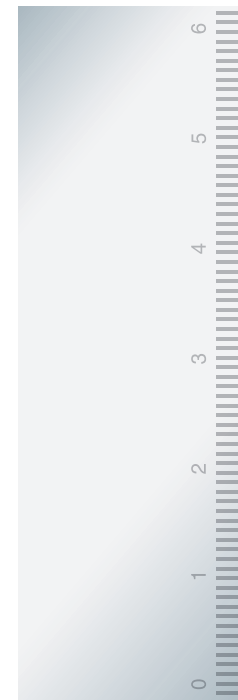

Zerosei



Woody

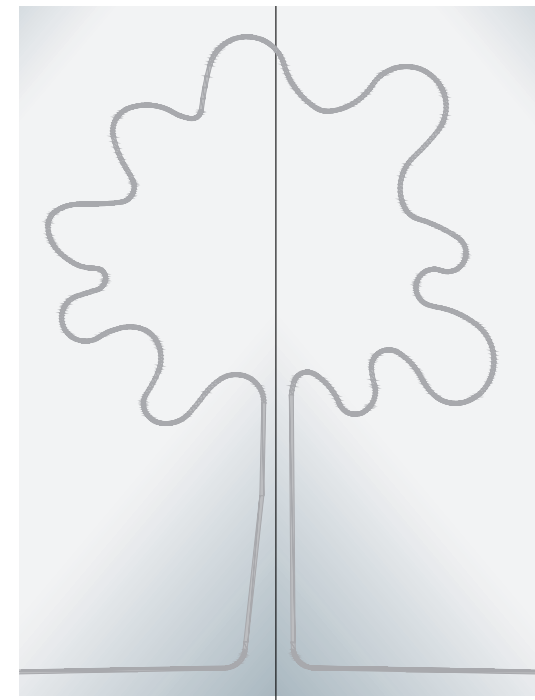

Double Woody

VETRO STRATIFICATO CON GRAFICHE STAMPATE NEI COLORI BLUINTERNI
MULTY LAYER GLASS WITH GRAPHIC PRINTS IN BLUINTERNI COLOURS



Extrachiaro Trasparente_
Transparent Extraclear



Laccati Bluinterni_
Bluinterni Lacquers

VETRO MONOLITICO
MONOLITHIC GLASS



Extrachiaro Trasparente_
Transparent Extraclear

Progetto grafico Lokomotiv
Fotografia/ Rendering Indoor
Fotolito Luce
Stampa Luce, Aprile 2016



FIAM srl
Via Castellana, 15
31010 Cimadolmo (Tv) Italy
T. +39 0422 748839
F. +39 0422 743521
www.bluinterni.it info@bluinterni.it

